

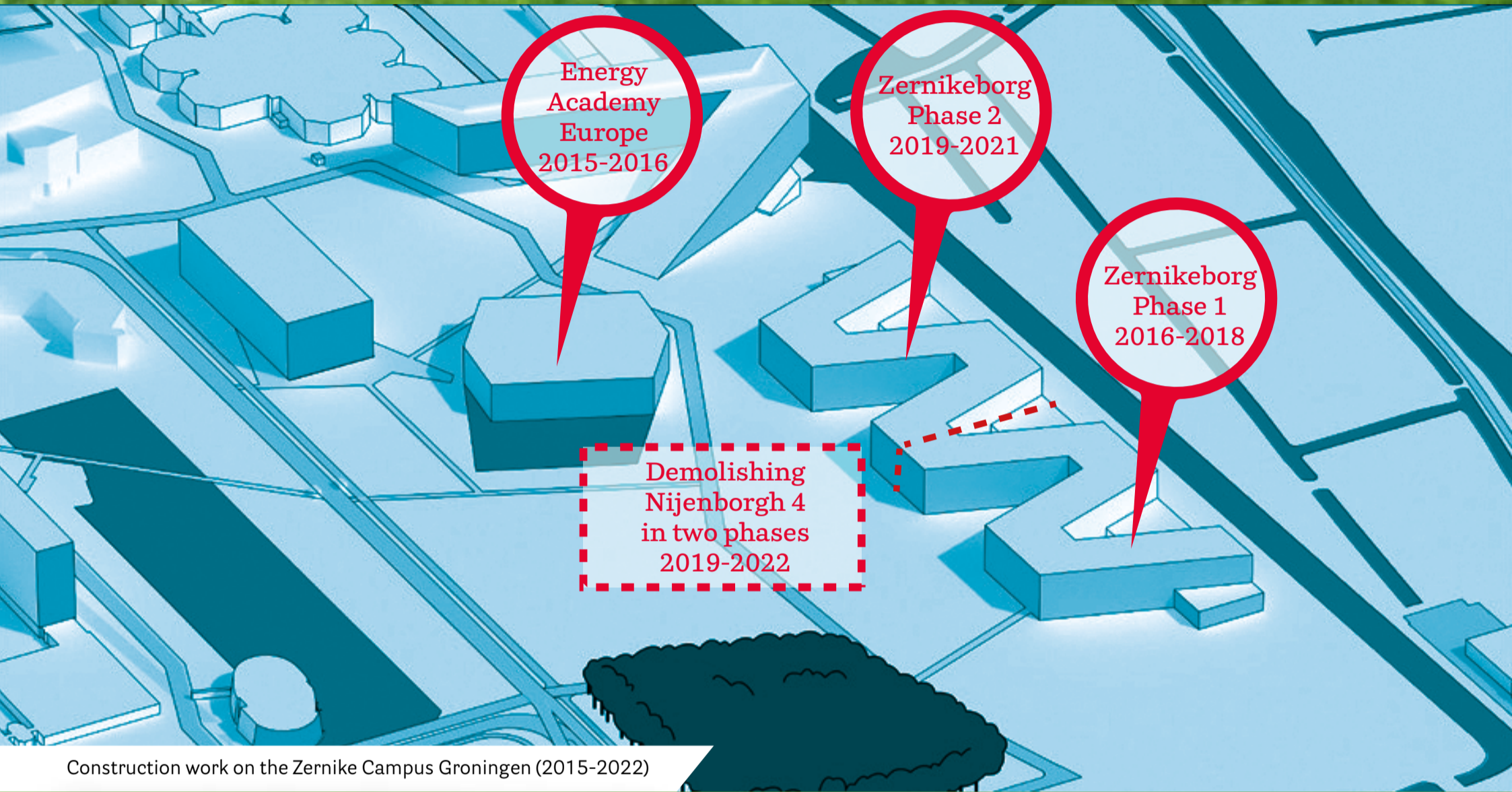

Groundbreaking Work | 2015 - 2022

Creating new buildings on the Zernike Campus Groningen



Construction work on the Zernike Campus Groningen (2015-2022)

Energy Academy Europe | 2015-2016

Energy Academy Europe is a new top institute in which the University of Groningen, Hanze University of Applied Sciences, Energy Delta Institute, Energy Valley, ESRIG, Energie Kenniscentrum, Services Department and Energy Academy Europe are joining forces to work together on research and innovation in the field of Energy. The key energy themes are gas, the energy of tomorrow, smart grids, energy efficiency, cost savings and CO2 reduction.

The new EAE building is itself a shining example of sustainability: it makes innovative use of renewable energy sources and operates a low-tech strategy (optimum usage of the natural elements earth, water, air and sun) to save energy and minimize operating costs, while offering high-grade facilities including various laboratories.



Zernikeborg | 2016-2021

The Zernikeborg for the Faculty of Mathematics and Natural Sciences covers approximately 53,000 m², making it the largest new building project that the University of Groningen will undertake in the near future. The new building will replace the outdated building at Nijenborgh 4, which houses world-famous top-class institutes for the sciences. The new building will provide room for some 850 staff and 1,400 students.

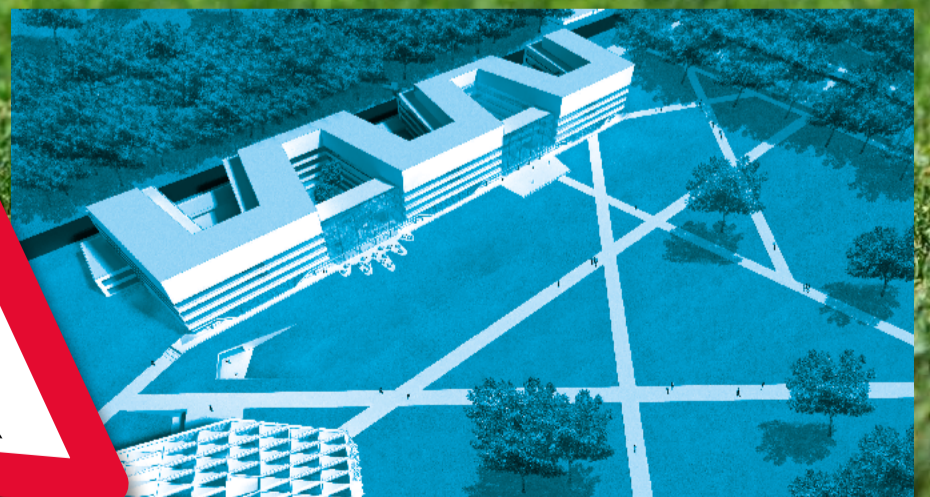

Construction work

Energy Academy Europe | 2015 - 2016

The Energy Academy Europe (EAE) looks like being the most sustainable education building in the Netherlands. In this building, business, education and science will all work together on research and innovation in the field of energy.

Construction work EAE

The actual construction of the Energy Academy Europe building will start on **18 March 2015**. The preparatory work has already begun: underground pipes have been moved, the paths around the building site have been adapted and some trees have been cut down. In the next few weeks we will be working towards the actual start of the construction work. The topsoil will be removed and preparations taken to screw long concrete piles into the ground. The new Energy Academy Europe building is planned to be ready in the **summer of 2016**.

Construction traffic route

Due to safety concerns parts of the cycle and pedestrian route along the Zernikelaan will be diverted. The bus lane will remain open to public transport.

How we reduce nuisance

Everyone who visits Zernike Campus Groningen in the coming period will be confronted with the construction work. In order to ensure safe traffic situations and to limit the nuisance to the immediate surroundings during the Energy Academy Europe construction period, the following measures have been taken:

- Construction **traffic** and other traffic will be **separated** as much as possible.
- Construction traffic may not travel faster than **30 km/h** with an eye to the **vibration-sensitive research** taking place nearby.

In addition, vibration sensitive research being conducted in nearby buildings has also affected the way that the Energy Academy Europe building will be constructed. Instead of the piles being driven into the ground, we use a technique to screw them in (> see video).

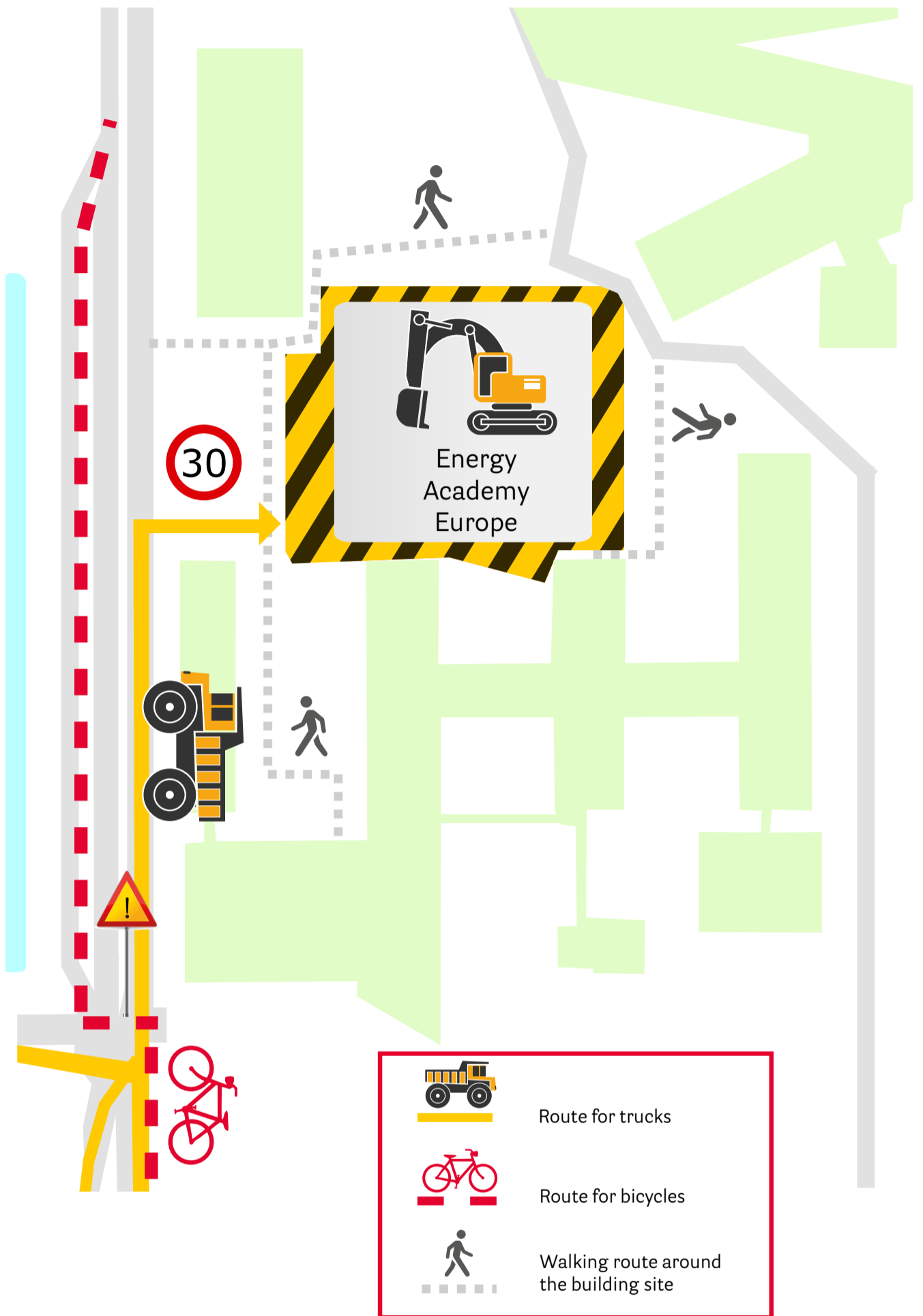

Zernikeborg | 2016 - 2022

The construction of Zernikeborg and the demolition work of Nijenborgh 4 will start at the end of 2016 and continue until 2022. The Zernikeborg will be built in two phases: the southern end of the Zernikeborg will be built first, on the location of the current car park. The first institutes will then move in and the rearmost buildings will be demolished, creating room for the construction of phase two.

Follow us for Groundbreaking News!

Receive updates about the construction work for the Energy Academy Europe and Zernikeborg online:

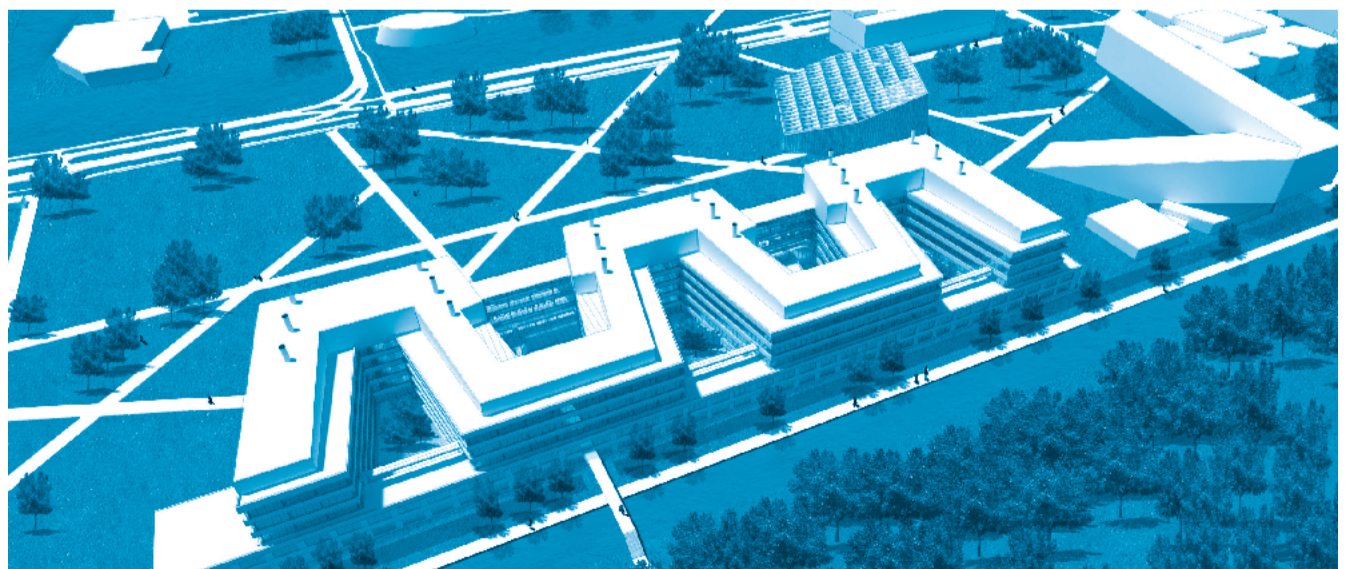

[fb.com/GroundbreakingWork](https://www.facebook.com/GroundbreakingWork)

www.rug.nl/GroundbreakingWork