



university of
groningen

faculty of behavioural
and social sciences

course catalogue 2016/2017

psychology

bachelor programme



Bachelor of Science in Psychology

**Study guide
2016 – 2017**

**Department of Psychology
Faculty of Behavioural and Social Sciences
University of Groningen**

Heymans building
Grote Kruisstraat 2/1
9712 TS Groningen

Contents

Part I – General Information

1. The Bachelor of Science in Psychology in Groningen	2
1.1 Aim of the Programme	2
2. Dates and timetables	3
2.1 The academic year	3
3 Student services.....	5
3.1 Means of communication	5
3.2 Student Services Desk (Onderwijsbalie)	5
3.3 Study advisors	5
3.4 Library Services	5
3.5 Computers and the ICT Service Desk	6
3.6 Statistical Consulting.....	6
3.7 Readers and Copy Services	6
3.8 International Office.....	6
3.9 Student Organization (VIP)	6
3.10 Facility Management	7
3.11 Canteen	7
4. Structure of the programme.....	8
4.1 The Major.....	8
4.2 The Minor.....	8
4.3 Honours College and Psychology Programme of Excellence.....	9
4.4 Types of Courses	9
5 Study Progress: rules and procedures.....	10
5.1 Binding Study Advice (in Dutch “Bindend Studie Advies” or BSA)	10
5.2 Mandatory course sequences.....	10
5.3 Exemptions.....	11
5.4 Registration for courses and Exams.....	11
5.5 Grade norms	12
5.6 Exam Results	12
5.7 Objections, appeals and complaints.....	13
5.8 Propaedeutical exam	13
5.9 Bachelor’s exam and Diploma Ceremony.....	14
6 Organizational structure of the Psychology programme	15
6.1 The Faculty board	15
6.3 The Department of Psychology.....	15
6.4 Committees.....	15
7 Practical information	17
7.1 Costs of Course Materials	17
7.2 Studying Abroad.....	17
7.3 Information activities.....	17
8 Faculty Contact Information.....	19
9 Map of the faculty	21
Part II – The programme in detail.....	22
10 The First Year – propaedeutic phase	23
10.1 Aims of the Propaedeutic Phase.....	23
10.2 Overview of the first year’s programme.....	23

11. The Second Year.....	24
11.1 Aims of the second year	24
11.2 Overview of the second year programme	24
12 The Third year	26
12.1 Aims of the third year	26
12.2 Programme	26
12.3 The minor package.....	26
12.4 The differentiation package.....	26
12.5 The Bachelor thesis.....	26
12.6 The list of courses in the third year	27
12.7 Year overview	29
Part III – Formal regulations.....	31
14. Teaching and Examination Regulations (OER) - Faculty	32
15. Teaching and Examination Regulations (OER) – Programme.....	58
16. Rules and Regulations.....	68
17. Code of Conduct.....	77
18. Student charter	79
19. Addresses Central bodies University of Groningen	81
Appendix: adaptations Study Guide as from August 2016.....	83

Part I – General Information

1. The Bachelor of Science in Psychology in Groningen

Welcome

to the Bachelor of Science in Psychology programme in Groningen.

Psychology is a multifaceted discipline, but broadly speaking it concerns how biology and culture interact to shape the normal and abnormal ways in which people think, feel, and interact with one another across the course of the lifespan. It has strong theoretical foundations and relies on the scientific method to evaluate new theories. The programme is academically oriented and provides a basis for further study and independent research. However, the skills acquired in communication, critical thinking, research, group processes, and assessment can be applied in a wide range of settings.

This study guide provides you with the necessary information about the aims and structure of the English bachelor's in Psychology degree programme.

The most important legal rules that apply to this programme can be found in the following documents:

- Student Charter
(<http://www.rug.nl/about-us/organization/rules-and-regulations/onderwijs/studentenstatuut/>)
- Teaching and Examination Regulations (OER), (chapters 14 and 15)
- Rules and regulations (chapter 16)
- Code of conduct (chapter 19)

All students who enrolled in the Psychology programme in Groningen are expected to be familiar with these rules. If unclear or inconsistent information is provided, even in this catalogue, then the formal rules always have priority.

1.1 Aim of the Programme

The B.Sc. in Psychology is a three-year degree programme designed to give a thorough understanding of the theoretical underpinnings of psychology and of how theories can be applied to everyday life. Research is the keystone on which the programme is built. In addition, it develops academic skills such as preparing reports and giving presentations and practical skills such as administering diagnostic tests and conducting interviews. This is how the programme intertwines education and research.

1.2 Aim of the Study guide

This Study guide provides an overview of the Bachelor programme, as well as a sketch of the options for subsequent Master programmes. The section *Rules and Guidelines* is especially important, for it lays out the rules of the game, as it were. Details of amendments, should they be made, will be sent to the student's university e-mail address, which should be checked regularly, and will be available on *Student Portal*, the electronic learning environment of the University of Groningen (see www.nestor.rug.nl and the community site for English language students, Bachelor Psychology EN, in particular).

2. Dates and timetables

2.1 The academic year

The academic year consists of two semesters. Each semester is divided into two blocks. Most courses are given in a single block, but a few span two or more blocks. Exams are held during the last two weeks of each block. Re-sits are held in the third week after the exams.

Semester 1						
Block 1a			Block 1b			
1 week	7 weeks	2 weeks	3 weeks	1 week	4 weeks	2 weeks
Start week	Lectures	Exams	Lectures	Re-sits	Lectures	Exams

Semester 2											
Blok 2a				Blok 2b							
3 wk	1 wk	4 wk	2 wk	3 wk	1 wk	4 wk	2 wk	1 wk	2 wk	1 wk	
Lectures	Re-sits	Lectures	Exams	Lectures	Re-sits	Lectures	Exams	Break	Re-sits	Break	

2.2 Dates

Semester 1: 5 September 2016 - 4 February 2017

Block 1a:	5 September 2016 - 10 September 2016	Study start week
	12 September 2016 - 29 October 2016	Lectures
	31 October 2016 - 12 November 2016	Exams
Block 1b:	14 November 2016 - 3 December 2016	Lectures
	5 December 2016 - 10 December 2016	Re-sits block 1a
	12 December 2016 - 21 January 2017	Lectures
	23 January 2017 - 4 February 2017	Exams

Semester 2: 6 February 2016 - 22 July 2016

Block 2a:	6 February 2017 - 25 February 2017	Lectures
	27 February 2017 - 4 March 2017	Re-sits block 1b
	6 March 2017 - 1 April 2017	Lectures
	3 April 2017 - 15 April 2017	Exams
Block 2b:	17 April 2017 - 6 May 2017	Lectures
	8 May 2017 - 13 May 2017	Re-sits block 2a
	15 May 2017 - 10 June 2017	Lectures
	12 June 2017 - 24 June 2017	Exams
	3 July 2017 - 15 July 2017	Re-sits block 2b

2.3 Holidays in 2016 – 2017

No lectures or examinations will be held on the following dates:

Winter Break	Monday 26 December 2016 – Friday 6 January 2017
Good Friday	Friday 14 April 2017
Easter Monday	Monday 17 April 2017
Kings Day	Thursday 27 April 2017
Liberation Day	Friday 5 May 2017
Ascension Day	Thursday 25 May 2017
Whitsun	Monday 5 June 2017
Summer Break	Monday 17 July 2017 – Friday 1 September 2017

Apart from these holidays you are expected to be available for educational activities on weekday in the period from 5 September 2016 until 21 July 2017.

2.4 Course schedules

Course schedules can be found on our website: www.rug.nl/gmw/roosters. Dates and times may alter during the year, even at the last moment. Also it may occur that, due to student number enrolments, the venue for a course or an exam changes at a late time. Therefore it is strongly advised to check the schedules regularly, especially in the week before the start of a block. No rights can be derived from any errors in the course schedules.

3 Student services

3.1 Means of communication

The Psychology programme uses different media to communicate with its students. These are:

E-mail: your RUG account, which can be accessed at: <http://googleapps.rug.nl>

Letters: to the address as known by the RUG through studielink

Studentportal: the digital learning environment: <http://studentportal.rug.nl>

ProgressWWW: The system for enrollment in courses and exams:

<http://www.progresswww.nl/rug>

To ensure for yourself that you don't miss any important information, it is very important to check these media regularly. Make sure to log on to the Studentportal regularly, so you catch up on the latest course announcements. Make sure you keep your mail address up to date. Important letters are sent by regular mail. **You yourself are responsible that you can be reached.**

3.2 Student Services Desk (Onderwijsbalie)

The Student Services Desk is staffed by members of the Department of Student and Academic Affairs. They handle all aspects of registration and student administration, including late registration for exams, providing transcripts, making appointments with academic advisors, etc. The Student Services Desk is located near the entrance to the library, on the first floor of the Heymans building.

Phone: 050 363 6301

For questions, first visit: www.rug.nl/gmw/vraagenantwoord

Hours: Monday - Friday, 9:00 am – noon, 13:00 pm - 17:00 pm

You can apply for authenticated copies of your diploma every Tuesday and Thursday between 14:00 and 15:00 pm. This service costs 5 euros for two complete sets of diplomas.

3.3 Study advisors

The study advisors provide information and advice concerning study plans and support, guidelines for enrolment and other personal issues. The study advisor can act as a contact person for students who are interested in following educational components outside the programme.

For questions about the study advisors, please consult www.rug.nl/gmw/vraagenantwoord, first.

Every day, at least one study advisor will have their office hour from 11.00 am - 12.00 noon. The office hours are meant for brief questions which can be dealt with within 5 to 10 minutes. Should you require more time for your issue, you are kindly requested to make an appointment via the students service desk.

Are you interested in more information about the study advisors, then please consult the following link: <http://www.rug.nl/education/study-advisors/>

3.4 Library Services

The Library of Behavioural and Social Sciences is situated on the first floor of the Heymans building. In addition to a wide range of specialist's books and journals, the library offers access to electronic journals and databases.

It is also possible to study in the library. There are about 130 study places and 24 student computers. You need a valid student card to borrow materials. Students may also use the other RUG libraries. The address:

Grote Kruisstraat 2/1

9712 TS Groningen

tel. 050 363 6555

e-mail: gmw-bibliotheek@rug.nl

internet: <http://myuniversity.rug.nl/infonet/studenten/bibliotheek/diensten/bibgmw/>

The opening hours of the Library of Behavioural and Social Sciences are: Monday – Thursday, 9.00 a.m. – 21.30 p.m. and Friday, 9.00 a.m. – 17.00 pm During holiday periods, opening hours are different.

3.5 Computers and the ICT Service Desk

Computer labs are spread throughout the Heymans and Munting buildings. Help with computer-related problems is available at the ICT Service Desk located on the ground floor of the Heymans building.

ICT Service Desk

Heymans building (ground floor), Room 50 A

Opening hours: 8:30 am – 17:00 pm

E-mail: citservicedesk@rug.nl

Phone: 050 363 3232

3.6 Statistical Consulting

Advice concerning research designs or statistical problems is available at the “Methodologiewinkel” (Methodology Advisory Shop), located on the first floor (Room 125) of the Heymans building.

Methodologiewinkel

Grote Rozenstraat 19, Room 0113 (first floor)

Phone: 050 363 6190

e-mail: methodologiewinkel@rug.nl

Hours: Monday – Friday, 13:00 pm – 17:00 pm

3.7 Readers and Copy Services

If a course requires a reader, it can be purchased at the Copy Shop, Grote Rozenstraat 3.

Copy Shop

Grote Rozenstraat 3

Phone: 050 363 6228

Opening hours: Monday – Friday, 8:15 am – 12:30 pm, 13:15 pm -16:30 pm

3.8 International Office

When you have questions on becoming an exchange student or studying abroad, you can contact the International Office at room Heymans 0025 (ground floor)

Phone: 050 363 6559

Opening hours: Monday – Friday 9:30 am – 11:30 am

3.9 Student Organization (VIP)

Psychology has a student organisation, the VIP. The VIP organises a range of activities throughout the year, including day trips to other institutions and career orientation activities. The VIP also matches “buddies” to international students, to aid the international student in navigating through the Dutch system and handling possible cultural issues.

An important advantage of membership of the VIP is that course books can be ordered through the VIP at a discount.

Contact information:

Website: www.vipsite.nl

e-mail: vip.gmw@rug.nl

Phone: 050 363 6323

3.10 Facility Management

For lost-and-found, reporting a defect printer or copier, to borrow a bicycle pump, or other related issues, you can turn to the front desk at the Heymansbuilding, Grote Kruisstraat 2/1, Tel. 050 363 6314. The front desk is open Monday to Thursday 8.00 am – 9.30 pm and on Fridays 8.00 am – 5.30 pm.

3.11 Canteen

The Heymansbuilding houses a canteen with fresh food. This canteen is open Monday to Friday 10.00am – 3.00pm. Breakfast is available from 10.00 am – 11.00 am.

Coffee and other vending machines for snacks and drinks are also situated in the canteen.

The Micaffé in the Gadourekbuilding is open Monday to Thursday 8.45 am – 4.45 pm and on Fridays 8.45am – 3.45pm.

4. Structure of the programme

Each year of the programme has a study load of 60 European Credit Transfer System credits (EC). The year consists of two semesters of 30 EC each. An EC consists of 28 h of study effort. The programme is based on a study effort of about 40 h/week, in 42 weeks of an academic year. The programme can be divided into various sub-parts. One important distinction is that between the propaedeutic phase and the post-propaedeutic phase. The propaedeutic phase comprises the courses that are being taught in the first year of the programme. It is considered the basis of the programme, without which students cannot successfully complete the remaining two years. This is mirrored in the rules for the Binding Study Advice (see section 4.3 and Teaching and Examination Regulations) and the rules that regulate access to higher-year courses (see section 7 Teaching and Examination Regulations). Moreover, the programme distinguishes between a Major and Minor part. The Major consists of 150EC (60 EC in the propaedeutical phase and 90 EC in the postpropaedeutical phase). The Minor comprises 30 EC in the third year and offers an opportunity for individual choices with respect to topics and courses. The various parts of the programme are explained in more detail below.

4.1 The Major

The first year of the Bachelor programme (the propaedeutic phase) introduces the entire field, with particular emphasis on the history of psychology and applications to the real world. Much of the curriculum fosters independent thinking and communication skills, a mastery of information search skills, and an understanding of the type of data psychologists use. Statistical techniques by which psychologists evaluate data are introduced; courses in social and cross-cultural psychology, developmental psychology, and personality and individual differences put the individual into a social and cultural context; a course in biopsychology explores the underlying role of biological processes in thought and behaviour; and a practicum provides a first chance to develop intervention and dialogue skills. The second year builds upon the first, elaborating on many topics introduced in the first year. There are courses on organisational, clinical, cognitive and social psychology with an emphasis on applications of these disciplines in different settings (e.g., the workplace, health settings, rehabilitation, and consumer behaviour). There are two more statistics courses, and test theory is introduced and applied in diagnostic skills and research practical. A course on the theory of science provides perspective for the topical courses. Finally, the year ends with a course on career paths and the competencies they call for. As part of this latter course the student develops a portfolio showcasing the skills acquired in the first two years and, with guidance, an individualized plan for the final year of the programme. Students continue the Major in the third year. They choose four specialization courses, at least two of which are from the same specialization. The specializations are closely related to the Master degree programmes offered at the University of Groningen: Applied Social Psychology, Clinical Psychology, Clinical Forensic Psychology and Victimology, Clinical Neuropsychology, Cognitive Psychology and Psychophysiology, Environmental Psychology, Reflecting on Psychology, Talent Development and Creativity, Traffic Psychology and Sustained Mobility, and finally Work, Organizational and Personnel Psychology. Finally, the bachelor thesis projects offer students an opportunity to get to know all phases of a research project. They work in small groups on a research project. Each student writes an individual thesis about the project.

4.2 The Minor

The third year of the programme also includes the Minor of 30 EC. This part of the programme can be realized according to the student's individual preferences:

- Students can do a Minor at the University of Groningen, but outside the Psychology programme, or
- They can do a *Free Choice Minor*. Students can choose 30 EC freely from courses offered in the Psychology Programme, or outside psychology, even abroad, or a mix of psychology and other courses.

4.3 Honours College and Psychology Programme of Excellence

The RUG has a university wide Honours College, offering an extra challenge to talented and motivated students. This programme has a study load of 45 credits on top of the 180 EC of the regular three-year Bachelor programmes. The Honours College programme consists of a broadening component (20 EC) and in-depth discipline-specific courses (25 EC). The latter are offered by lecturers at the Psychology programme.

The selection procedure for the Honours College takes place at the end of the first semester. First-year undergraduates have the opportunity to apply for a place in the Honours College. Information on this selection procedure is available on the website of the Honours College, www.rug.nl/honours/index.

For talented students who do not participate in the Honours College, there may be an opportunity to enroll in second and third -year courses originating from the discipline-specific part of that Honours programme. These courses are offered in a Psychology-specific Programme of Excellence that is offered next to the regular courses in the major-minor programme. The study load is 20 EC on top of the 120 EC of the regular second and third year Bachelor's programme. Please see article 3.7 of the Teaching and Examination Regulations) for a description of the courses in this Programme of Excellence.

Important: The Programme of Excellence is offered only when there are vacancies after the Honours College has completed their selection procedure.

More information about the in-depth disciplinary part of the Honours College programme and the Psychology-specific Programme of Excellence can be found on Student Portal.

4.4 Types of Courses

Lecture courses: Lectures introduce the relevant theory. They complement and extend the assigned literature for the course. To ensure that their content and ramifications are thoroughly understood, lectures may be complemented by practical exercises and/or assignments. Lecture courses are tested with exams and/or papers. Attendance at lectures is optional, but their content will usually be tested in the exam.

Practicals: Many courses, or parts thereof, take the form of practicals, in which the emphasis is on developing and practicing skills. Attendance is mandatory and assignments and exams may be given.

Literature studies:

Students receive a pre-specified list of readings that have to be studied individually.

Bachelor's thesis: The Bachelor's thesis is a written report documenting all phases of a completed empirical research project.

Each course will be offered once every year. The amount of EC is determined before the start of a course. For some courses, assignments, essays or presentations are mandatory and as such part of the exam.

5 Study Progress: rules and procedures

5.1 Binding Study Advice (in Dutch “Bindend Studie Advies” or BSA)

The Binding Study Advice (*Bindend Studie Advies*, BSA) is a rule that has been introduced university-wide in order to make sure that students early-on during their education find the right programme and receive the right kind of support. Specifically, full-time students are bound to the following rule:

- During their first year in the programme they must pass for at least 45 out of 60 ECs from the propaedeutic phase (i.e., the first-year courses). Failing to do so results in exclusion from the programme (*binding study advice*).

Students who nevertheless want to re-enroll into a Psychology programme have to wait for at least two years. For more information (e.g., with respect to exceptions, Force Majeure, etc.) please refer to the RUG website. Here, you can also find information about how to appeal a BSA.

Students with exceptional conditions (e.g. dyslexia, family problems) due to which they may fail to collect 45 EC, are advised to make an appointment with an academic advisor in time.

Please note: Article 5.2.4 of the Faculty Teaching and Examination Regulations states that students must pass their propaedeutic exam within a maximum period of two years and failing to do so would result in exclusion from the programme. At this moment there is no clarity as to the juridical validity of this rule. Therefore, until further notice, the programme does not execute this regulation.

5.2 Mandatory course sequences

In the bachelor's programme, some courses require previous knowledge from other courses in order to be completed successfully. Therefore, these courses must be taken in a specific, pre-defined order. For the detailed set of rules, please refer to the respective sections (Paragraph 4 Teaching and Examination Regulations). The most important rules are summarised here:

For students who have started the programme in 2009-2010 or earlier, the following rules hold:

1. You can only register for second-year exams (which are part of the compulsory post-propaedeutic programme) after having completed a minimum of 45 ECs of propaedeutic courses, including the courses *Introduction to Psychology* and *Statistics IA*.
2. In the third year of the Psychology programme, you cannot register for any exam if you have not fully completed your propaedeutic phase. This rule includes students who enrolled later than September.

For *all* students hold:

<i>In order to register for:</i>	<i>You first need to pass:</i>
Second year courses	Propaedeutical exam (P) or (provisional) positive BSA (+B)
Test Theory (<i>PSBE2-06</i>)	P or +B with Statistics IA (<i>PSBE1-08</i>) and/or Statistics IB (<i>PSBE1-09</i>)
Statistics II (<i>PSBE2-07</i>);	P or +B with Statistics IA (<i>PSBE1-08</i>) and Statistics IB (<i>PSBE1-09</i>), or having passed either one, and the other is graded with minimally 5. The permission remains valid even after the course that was initially graded 5 is graded lower after the

	resit. (
Statistics III (<i>PSBE2-12</i>) Research Practicum (<i>PSBE2-09</i>)	P or +B with courses Statistics IA (<i>PSBE1-08</i>) and Statistics IB (<i>PSBE1-09</i>) passed, and having passed the practical requirement of Statistics II (<i>PSBE2-07</i>)
All third year courses	Propaedeutical exam (P)
Independent Societal Internship (<i>PSB3E-SI</i>)	Clinical Psychology (<i>PSBE2-22</i>), Psychology in the workplace (<i>PSBE2-03</i>), Social environment and behaviour (<i>PSBE2-04</i>), Theory of Science (<i>PSBE2-05</i>), Communications and diagnostic skills (<i>PSBE2-11</i>), Career perspectives (<i>PSBE2-13</i>) and of of the following two courses: Cognitive psychology (<i>PSBE2-23</i>) and Introduction to Clinical neuropsychology (<i>PSBE2-24</i>) (or the former combined course <i>PSBE2-21</i>)
Bachelor's thesis (<i>PSBE3-BT</i>)	Test theory (<i>PSBE2-06</i>) and Research methods (<i>PSBE2-08</i>) and Research practicum (<i>PSBE2-09</i>) and either Statistics II (<i>PSBE2-07</i>) or Statistics III (<i>PSBE2-12</i>)

Apart from the sequences in above table, there are also some third year courses with prerequisites. For the full overview please see Chapter 15: Teaching and Exam Regulations (OER).

5.3 Exemptions

Exemptions from a course may be issued on the basis of a previous course or study. Completion of a first-year psychology programme elsewhere in The Netherlands warrants exemption from the first-year courses here. A request form for individual course exemptions, available at the Student Services Desk, should be submitted to the Examinations Committee. For the Bachelor Thesis no exemption will be granted.

5.4 Registration for courses and Exams

!Registration for courses and exams is mandatory!

Registering for courses

It is necessary to register for each course, whether lecture, practicum or Bachelor's thesis. You can register for courses from the start of the block preceding the block in which the course is scheduled up until five weeks after the course has begun. An exception is made for practicum courses. For these courses registration ends two weeks before the course begins. For courses taught in the first block, registration starts at the beginning of August. Students must register online, via the internet site *ProgressWWW* (<https://progresswww.nl/rug/>). First-year students will be registered for the courses (and exams) of the first semester by the Student Service Desk. Registering for courses in the second and third year is possible from August 15. Enrollment for the Psychology in Society university minor has to be done before August 1. In the third year you can not sign up for more than four courses per block without permission from an academic advisor or the exam committee. Third-year's courses only are accessible after having completely finished the first-year's programme.

New as of 2014-2015

As soon as you successfully register for a course, you are also registered for the first exam opportunity for that course. If you fail or do not attend, you are automatically registered for the resit. Only if you want to redo a passed exam, e.g., to get a better grade, you have to let yourself register by the Student Service Desk. Be aware: the last result (not the highest) will count.

Each course has two exams per year. Practicals can be followed at least once a year. Date and place of exams are published online, in the courses' time tables: <http://www.rug.nl/gmw/roosters>

Special rules for practicals:

Students who have registered for a practical, but fail the practical because of a lack of attendance, can only re-do the practical at a later point in time *if there is a sufficient number of places left*. For mandatory courses, the programme plans a sufficient number of places (yet, you will be admitted last). For Minor or specialisation courses, however, it is possible that the course is full, meaning that you cannot follow the course a second time.

Partial exams

In the first year, a number of courses offer partial exams. That is, the first exam takes place after several weeks of the course, and the second exam takes place during the subsequent exam period.

5.5 Grade norms

The students' knowledge may be tested by means of essay question exams, papers, or multiple choice exams.

In order to pass a multiple choice exam, students must know the answers to 56% of the questions, with chance being taken into account. For example, in an exam with 60 three-choice questions, students are expected to score 20 questions correct on the basis of chance alone. Thus, they need to pass at least 20 questions plus $(60-20)*56\%$, which sums up to 42,4. Please note that this differs from a scheme that simply requires 56% of correct answers!

The results of an exam are always rounded to full grades. The results of a bachelor's thesis and two other courses may be expressed in half grades (5.5 will not be used), but must always be at least 6.0 to pass.

5.6 Exam Results

All exams and papers are graded and the grades are submitted to the registrar within five (multiple choice) or ten (all other exam forms) working days. Grades for oral exams are determined as soon as the exam is concluded. Grades are posted on ProgressWWW, where you can inspect them. Only results on Progress are valid: no rights can be claimed from feedback given by the lecturer on Student Portal. A hard copy of one's grades can be requested at the Student Services Desk. In the case of multiple-choice exams, the key for the exam is posted on Student Portal within 1 working day of the exam whenever it is anticipated that grades will not be posted within 5 working days. Annually in October you are provided with the results of the previous academic years per e-mail. Partial exams have no separate results: only after the last partial the result of the entire exam will be determined. Because questions may be re-scored or dropped it is not possible to determine a grade on the basis of the exam key.

The course instructor will arrange at least one opportunity to inspect exam questions. However, this opportunity is limited to only those students who actually took part in the exam.

5.7 Objections, appeals and complaints

Examinations

When you don't agree with the result of an exam or a decision regarding examination, you can send an appeal to the examinations committee within six weeks of publication of the result.

To contact the Examinations Committee, a signed letter (not an e-mail) should be sent via the secretarial support of the Committee, Ms. J.M. Baan. Your letter should be clear and succinct, and should contain your name, address, and student number. If you mention specific courses, please indicate both the titles and the course codes. The Examinations Committee will issue a written response within two weeks (except for July and August, when a decision may take longer) of receiving the letter.

Address:

Examinations Committee
Ms. J.M. Baan
Grote Kruisstraat 2/1
9712 TS Groningen
Tel. 363 6366

Additional information about the Examinations Committee can be found on the Student Portal Bachelor community site (www.nestor.rug.nl).

You can appeal a decision of an examiner or the examinations committee. This appeal must be submitted to the *Board of Appeal for Examinations* (College van Beroep voor de Examens, CBE) within six weeks after the formal decision. You can find the corresponding procedure explained on the following site:

<http://www.rug.nl/studenten/regelingen/klachtenBezwaarBeroep>

Programme

In case you think that the *programme* fails to provide a correct service, you can make use of your right for *collective complaints* (collectief beklag). The complaint must be signed by at least five students and must be submitted to the Dean of the Faculty of Behavioural and Social Sciences. The right for collective complaints has been defined in the faculty rules.

Other matters

In case you have complaints and/or questions regarding *other matters* (discrimination, discourteous treatment, stalking etc.) you can get in touch with the RUG Confidential Advisor, Visserstraat 47-49, 9712 TC Groningen, Phone: 050 363 5435, email: secretariaatBVP@rug.nl. You can also visit the Central Portal for the Legal Protection of Student Rights (CLRS): <http://www.rug.nl/education/laws-regulations-complaints/>

5.8 Propaedeutical exam

Upon successful completion of the first-year programme a "propaedeutical" diploma will be issued. Students will automatically receive an invitation for the diploma presentation, which takes place two times per year. The corresponding dates can also be found on Student Portal. After determination of the propaedeutic exam, you cannot resit courses that are part of the propaedeutic programme.

5.9 Bachelor's exam and Diploma Ceremony

The Bachelor's diploma is awarded after completion of the 180 EC degree programme, although the Examinations Committee has the right to conduct an additional examination of the candidate. Requesting the diploma has become a part of the electronic submission of the bachelor's thesis. When submitting their thesis to the library system, students will be linked through to a page in *ProgressWWW*. Here, they can edit their personal details and subsequently select the courses that they want to be shown on the diploma supplement. If necessary, they can also specify the courses that they are *planning* to add to the list. The resulting list of program units will be submitted to the exam committee for approval and students will receive the decision per email. After the diploma has been requested, the list of program units has been approved, and all exams have been passed, the official diploma will be printed. Students can follow the course of their application via *ProgressWWW*. In case of changes (e.g., because a student unexpectedly did not pass a planned exam), the application can be changed at the Student Service Desk.

If a student would like to follow additional classes, on top of the required 180 ECs, he/she is required to include those courses in the official list of program units that is submitted to the exam committee. Students who fail to do so will not have the opportunity to follow additional courses, as they have formally completed the programme.

Students who are waiting for their final diploma to be issued can request a preliminary document from the exam committee, if all requirements of the diploma have been met.

The diploma ceremony for the Bachelor's degree takes place four times per year. The dates of the diploma ceremonies can be found at the Student Portal Bachelor Community site.

Please note that, if students hand in their request for the diploma too late, the exam committee can decide to assign a different end date for the programme. That is, the official end date will differ from the date of the last exam (i.e., the normal end date). *In some cases, this may require the student to enroll for an additional year.*

After being awarded with the diploma you are entitled to the degree "Bachelor of Science" and to use the abbreviation BSc after your family name: A.B. Familyname BSc.

6 Organizational structure of the Psychology programme

6.1 The Faculty board

The Department of Psychology is part of the Faculty of Behavioural and Social Sciences. The faculty is managed by the Faculty Board, which includes the dean (Prof dr. C.W.A.M. Aarts) , vice-dean (Prof. dr. M.P.C. van der Werf), portfolio Finances (Dr. R.J. Landeweerd), and an advisory student member.

6.2 The Faculty council

The participation of staff members and students of the Faculty of Behavioural and Social Sciences (BSS) is arranged by law via the Faculty Council and consists of nine elected staff and student members, respectively. The nine seats of the student representatives are divided between the two student parties, SVGMW and PSB, on basis of the election outcome.

The Faculty Council discusses various matters regarding education, research, personnel management, and finances. There are a number of recurring issues, such as the education and examination regulations (Dutch abbreviation: OERen) and the strategic plan of the faculty, but the members can also contribute ideas themselves about matters that concern the entire Faculty.

Contact in general: faculteitsraad.gmw@rug.nl; Contact SVGMW: svgmw@rug.nl; Contact PSB: psb.gmw@rug.nl

6.3 The Department of Psychology

The Department of Psychology has two programmes: a bachelor programme and a master programme. All research is managed by the Heymans institute. The department has two directors: a director of teaching and a director of research. The *director of teaching* is responsible for the planning and implementation of the department's teaching programmes. He/She is advised by the Educational Committee.

Director of teaching Psychology: Prof. dr.S. Otten

Secretariat: Mw. S.E.A. Heimink-Groot

Daily coordination of the bachelor programme: Dr. F.J.J.M. Steyvers

Address of the Department:

Heymansgebouw and Muntinggebouw

Grote Kruisstraat 2/1

9712 TS Groningen

Opening hours: Monday-Thursday, 8.00 am-9.30 pm, Friday 8.00 am-5.30 pm.

Phone: 050 363 6314 (porter's desk).

Teaching takes place in various locations. Small-group courses are mainly taught in our buildings in Bloemstraat 36.

6.4 Committees

Educational Committee

This committee exists of four staff and four student members. The committee advises on matters pertaining to the Teaching and Examination Regulations, the programme, quality control and course evaluations. Students can contact the Educational Committee via e-mail: ocpsychologie@rug.nl

Chair: Prof. dr. K.A. Brookhuis

Secretary: Mrs. S.E.A. Heimink-Groot

Examinations committee

The Psychology Bachelor Programme has an Examinations Committee. The Examinations Committee deals with requests for exemptions from an examination, and applications for the Propaedeutic and Bachelor certificates. The Examinations Committee is also accessible for requests and complaints with respect to Exams. Before contacting the Examinations Committee, please read the corresponding regulations carefully. In particular, the following documents provide the basis for possible exemptions, requests or complaints: the *Teaching and Examination Regulations* (OER), the *Rules and Regulations* and the *Student Charter Section*. These documents are part of the study guide. Furthermore, in case of complaints, please first contact the teacher of the course, the year coordinator and the Program coordinator (in that order) before you turn to the Examinations Committee. Requests for exceptions to the rules will be granted only if the issue was for a demonstrable reason beyond the student's control. If you doubt whether your request/complaint is an issue to be dealt with by the Examinations Committee, please contact the Academic Advisor.

Chair: prof dr. M.E. Timmerman

Secretary: Dr. F.J.J.M. Steyvers

Secretariat: Ms. J.M. Baan

Admission committee masters programme of Psychology

Each student who wants to be admitted to the masters programme of Psychology has to submit a request to the admission committee. This is necessary for both students with the Bachelor's diploma Psychology from Groningen and a Bachelor's diploma from another Research University. Information about the admission procedure can be found at:

<http://myuniversity.rug.nl/infonet/studenten/gmw/onderwijs/schedule-and-registration-form>

Chair: prof. dr. J.J. Van der Meere.

Secretariat: mw. A.I. Emmen

7 Practical information

7.1 Costs of Course Materials

The costs of course materials (i.e., books, readers, etc.) are €700,- during the propaedeutic programme (first year) and about €1400,- for the major programme (second and third year). The respective costs are listed together with the course description. Please note that additional costs (e.g., depending on the minor) are possible, but that in general we follow the official policy of the University of Groningen. According to this policy, the amount of money that students are required to spend on study materials should not exceed the government grant. Each programme phase (propaedeutic, post-propaedeutic or Master) therefore has a cost 'ceiling' of € 740,- per year. In rare cases, students might have to go beyond the ceiling amount. If that is the case, it is possible to apply to the *Faculty Board* for reimbursement of half the extra expenditure, provided that receipts are submitted as proof. Further information can be obtained from your academic advisor or from the University Student Service Desk.

7.2 Studying Abroad

For most students of the English-language programme, Groningen is abroad. However, students may further broaden their experience by studying at another university. In most cases, studying at another university will consist of completing the minor requirement abroad. The international study coordinator can provide information about the possibilities for funding.

For general advice and to talk about how study abroad can complement your study here, contact dr. S.M. (Stacey) Donofrio.

dr. S.M. (Stacey) Donofrio
 e-mail: s.m.donofrio@rug.nl
 Room: Heymans 209
 Tel.: 363 7034
 Office hour: Tuesday 3:00 pm - 5:00 pm

7.3 Information activities

During the academic year various information activities are being organized. In the table below, you will find an overview of all of the regular information activities. In the introductory lectures, relevant and practical information for the upcoming academic year is being presented.

Event	Period	Announcement
1 st years introduction lecture	Early September	Invitation through: www.rug.nl/psy/start_up_info
2 nd years introduction lecture	Early September	- Invitation through e-mail - Announcement in Student Portal - Announcement on the information screens - Announcement through: www.rug.nl/psy/start_up_info
3 rd years introduction lecture	Early September	- Invitation through e-mail - Announcement in Student Portal - Announcement on the information screens - Announcement through: www.rug.nl/psy/start_up_info

Master your Talent	November and March	<ul style="list-style-type: none">- Announcement in Student Portal- Announcement on the information screens- Announcement through: www.rug.nl/masteryourtalent- Announcement on posters in the Faculty
--------------------	--------------------	--

8 Faculty Contact Information

Phone	Name	Office hour	Office
363 6406	Akyürek, dr. E.G.	Tues 10.00-12.00	0270 H
363 8239	Albers, dr. C.J.	By appointment	0181 H
363 6772	Brookhuis, prof. K.A.	Fri 10.00-12.00	0203 M
363 7608	Bouman, dr. T.K.	By appointment	0306 H
363 6486	Dalley, dr. S.E.	Wed 14.00-16.00	0414 HV
363 6479	Daniels, dr. J.K.	By appointment	0320 H
363 6338	Derksen, dr. M.	Mon 13.00-15.00	0163 H
363 8729	Dijkstra, prof. A.	Wed 09.00-11.00	0418 HV
363 7034	Donofrio, dr. S.M. 1	Tues 15.00-17.00	0209 H
363 6457	Eijbergen, prof. R. van	By appointment	0457 H
363 7632	Epstude, dr. K.	Thurs 11.00-13.00	0409 H
363 9729	Fürmaier, dr. A.B.M.	By appointment	0209 M
363 6395	Gordijn, prof. E.H.	By appointment	0417 H
363 8299	Greijdanus, H.J.E., dr. 9	By appointment	0415 Hv
363 9421	Groen, dr. Y. 6	Tues 15.00-17.00	0370 H
363 6424	Heesink, dr. J.A.M.	Wed 10.00-12.00	0486 H
363 7609	Hout, dr. W.J.P.J. van	Tues 12.00-14.00	0304 H
363 6764	Huntjens, dr. R.J.C.	Wed 10.00-12.00	0331 H
363 6348	Jolij, dr. J.	Fri 10.00-12.00	0255 H
363 6403	Jong, prof. P.J. de	Fri 15.30-17.30	0312 H
363 6463	Jong, prof. R. de	Mon 09.00-11.00	0268 H
363 6309	Jonge, prof.dr. P de	By appointment	0378 H
363 6384	Johnson, prof. A.	Tues 13.00-15.00	0241 H
363 6461	Keizer, dr. K.E. 8	Mon 14.00-16.00	0449 H
363 6342	Klavina, dr. L.	Wed 09.00-11.00	0239 H
363 6016	Koerts, dr. J.	By appointment	0363 H
363 6330	Kunnen, dr. S	By appointment	0371 H
363 6236	Leander, dr. N.P.	By appointment	0473 H
363 9730	Lommen, dr. M.J.J.	Tues 12.00-14.00	0333 H
363 6376	Lorist, prof. dr. M.M.	By appointment	0262 H
363 6407	Meere, prof. dr. J.J. vd	By appointment	0368 H
363 6339	Meijer, Prof. R.R.	By appointment	0180 H
363 6450	Nauta, dr. M.H.	Wed 13.00-15.00	0325 H
363 6754	Nieuwenstein, dr. M.R.	Tues 13.00-15.00	0257 H
363 4722	Ostafin, dr. B.D.	Wed 13.00-15.00	0317 H
363 7903	Otten, prof. dr. S. 4	By appointment, mon 14.00-15.00	0412 H
363 7021	Ravenzwaaij, dr. D.	By appointment	0169 H
363 7901	Romeijn, J. MSc. 3	By appointment	0212 H
363 6630	Rot, dr. M. aan het	Wed 13.00-15.00	0315 H
363 6290	Rijn, dr. D.H. van	By appointment	0276 H
363 6778	Sarampalis, dr. A.	Mon 14.00-16.00	0285 H
363 7904	Scheibe, dr. S.	By appointment, mon 16.00-17.00	0471 H
363 6244	Schleim, S. MA	By appointment	0179 H
363 7993	Steenbeek, dr. H.W.	By appointment	0384 H

363 6482	Steg, prof. E.M.	By appointment		0462 H
363 6782	Steyvers, dr. F.J.J.M. 5	Mon	09.00-11.00	0207 H
363 6509	Stroebe, dr. K.E.	By appointment		0415 H
363 6953	Tendeiro, drs. J.N.	By appointment		0185 H
363 9164	Tucha, prof. dr. O.M.	By appointment		0360 H
363 9165	Tucha-Mecklinger, dr. L.I.	By appointment		0373 H
363 6454	Vries, dr. P.H. de 7	Mon	09.30-11.30	0273 H
363 6761	Waard, prof. dr. D. de	By appointment		0205 M
363 7617	Wessel, dr. J.P.	Wed	09.00-11.00	0314 H
363 6238	Wolthuis, E.M. 2	Vr.	10.00-12.00	0212 H
363 6466	Wijers, dr. A.A.	By appointment		0279 H
363 6511	Zomeren, prof. dr, M. van	By appointment		0406 H

- 1 Internationalization coordinator
- 2 Alumni coordinator
- 3 Policy Officer Psychology
- 4 Director of Teaching
- 5 Programme coordinator
- 6 1st-year coordinator
- 7 2nd-year coordinator
- 8 3th-year coordinator
- 9 Coordinator Bachelor thesis

Coordinator: **Programme: General**
 Dr. F.J.J.M. (Frank) Steyvers
 e-mail: F.J.J.M.Steyvers@rug.nl
 Room Heymans 0207
 Tel: 363 6782
 Office hour: Monday 9.00 am- 11.00 am

The Propaedeutic Phase

Various coordinators

Coordinator: **Programme: The Second Year**
 Dr. P.H. (Pieter) de Vries
 e-mail: p.h.de.vries@rug.nl
 Room Heymans 0273
 Tel: 363 6454
 Office hour: Monday 09.30 am-11.30 am

Coordinator: **Programme: The Third Year**
 Dr. K.E. (Kees) Keizer
 e-mail: k.e.keizer@rug.nl
 Room Heymans 0449
 Tel: 363 6461
 Office hour: Wednesday 11.00 am – 13.00 am

Bachelorthesis
 Coordinator: Dr. H.J.E. (Hedy) Greijdanus
 e-mail: h.j.e.greijdanus@rug.nl
 Room Heymans 0231
 Tel: 363 8299;
 Office hour: By appointment

9 Map of the faculty

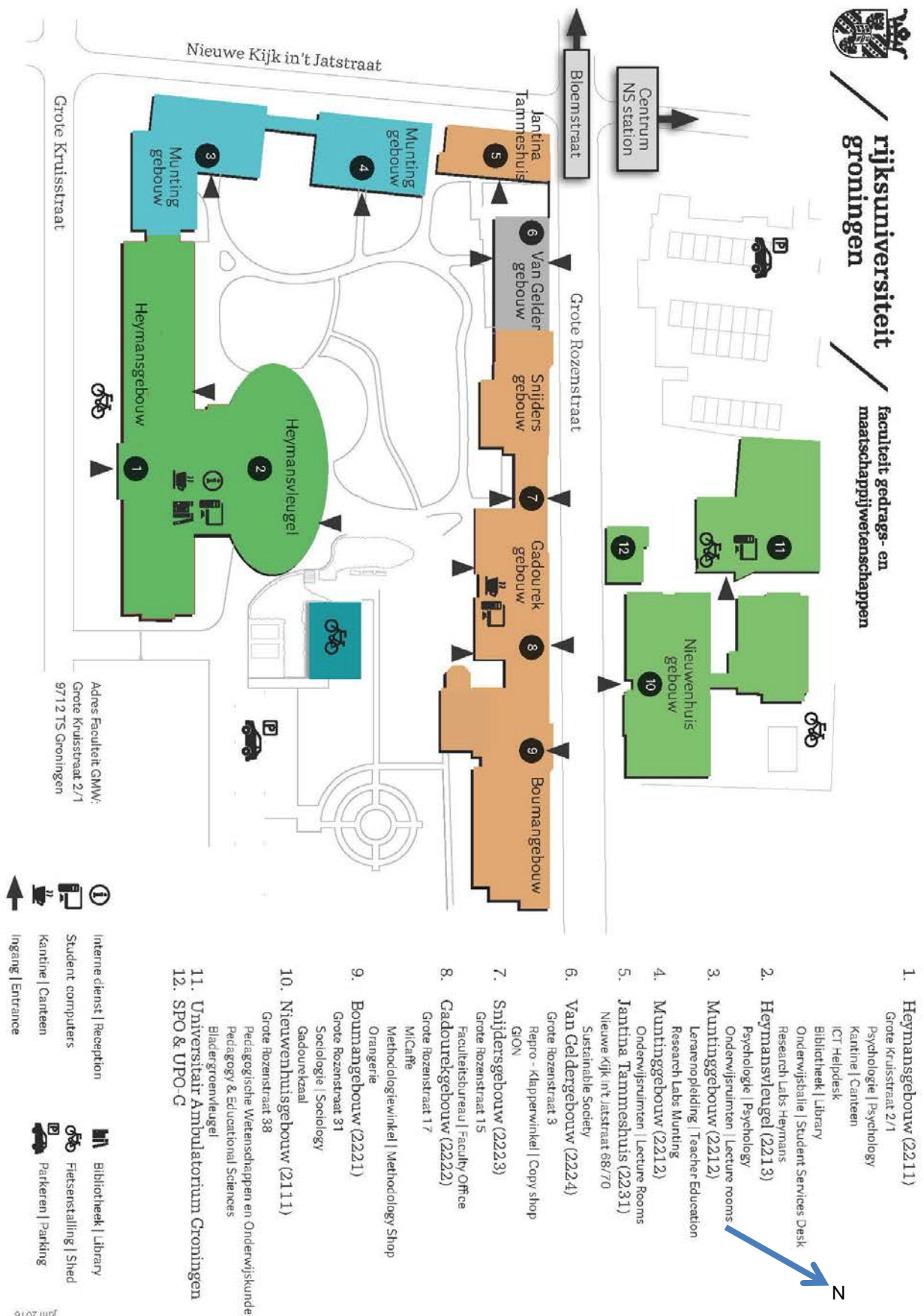

Part II – The programme in detail

10 The First Year – propaedeutic phase

Coordinator: various coordinators

10.1 Aims of the Propaedeutic Phase

The aims of the propaedeutic phase are:

1. To acquire an introductory overview of:
 - a the foundations of psychology
 - b and her methods and techniques
2. To acquire an orientation on the discipline:
 - a where it concerns research
 - b where it concerns working as a professional in the field
3. To improve the reflective abilities of the student

10.2 Overview of the first year's programme

Semester I		Semester II	
Block Ia	Block Ib	Block IIa	Block IIb
Introduction to psychology (PSBE1-01) 5ec	Psychology : history and application (PSBE1-26) 5ec	Developmental psychology (PSBE1-03) 5ec	Personality and individual differences (PSBE1-05) 5 ec
Statistics-Ia (PSBE1-08) 5ec	Statistics-Ib (PSBE1-09) 5ec	Social and cross-cultural psychology (PSBE1-02) 5ec	Biopsychology (PSBE1-04) 5ec
		Dialogue and group skills (PSBE1-17) 5 ec	
Introduction to research methods (PSBE1-24) 7,5ec			
Academic Skills (PSBE1-25) 7,5ec			

Block	code	course	EC
Block 1a	PSBE1-01	Introduction to psychology	5
Block 1a	PSBE1-08	Statistics 1a	5
Block 1b	PSBE1-26	Psychology: history and application	5
Block 1b	PSBE1-09	Statistics 1b	5
Block 2a	PSBE1-02	Social and cross-cultural psychology	5
Block 2a	PSBE1-03	Developmental psychology	5
Block 2b	PSBE1-05	Personality and individual differences	5
Block 2b	PSBE1-04	Biopsychology	5
Block 2a and b	PSBE1-17	Dialogue and group skills	5
Block 1a/b and 2a/b	PSBE1-24	Introduction to research methods	7,5
Block 1a/b and 2a/b	PSBE1-25	Academic Skills	7,5

11. The Second Year

Coordinator: Dr. P.H. de Vries, phone: 363 6454

11.1 Aims of the second year

The aims of the second year are:

1. To acquire an overview of the most important application fields in psychology and the methods and techniques of the academic practice of psychology. Learning theory and skills for designing, setting up and carrying out psychological research.
2. Deepening of professional skills and acquiring further knowledge on career perspectives and the next part of the program.

11.2 Overview of the second year programme

All courses in this year are compulsory, with the following exception: students must follow either Cognitive Psychology or Introduction to Clinical Neuropsychology as a compulsory part of their second year. Additionally they can follow the other course during their third year.

Semester 1 and 2	PSBE2-14	Academic fields	5
Block 1a	PSBE2-06	Test theory	5
Block 1a	PSBE2-23	Cognitive psychology	5 or*
Block 1a	PSBE2-24	Introduction to clinical neuropsychology	5
Block 1a and b	PSBE2-07	Statistics 2	5
Block 1a and b	PSBE2-11	Communication and diagnostic skills	5
Block 1b	PSBE2-22	Clinical psychology	5
Block 1b	PSBE2-03	Psychology in the workplace	5
Block 2a	PSBE2-04	Social environment and behaviour	5
Block 2a	PSBE2-08	Research methods: theory and ethics	5
Block 2a and b	PSBE2-09	Research practicum	5
Block 2a and b	PSBE2-12	Statistics III	5
Block 2b	PSBE2-05	Theory of science	5

* For your second year you must choose BE2-23 or/and BE2-24. During your third year you can follow the other course.

Honours Programme

Block	code	course	EC
Block 2a/b	PSBE2-HO1	Research seminar	2
Block 1a/b and Block 2a/b	PSBE2-HO6	Research internship I	5
Block 1a/b and Block 2a/b	PSBE2-HO3	Thematic meetings	4

Additionally, for students participating in the Honours College or Excellence programme, the regular course PSBE2-09 Research Practicum is replaced by PSBE2-H09 Honours Research Practicum.

Semester I		Semester II	
Block 1 a	Block 1 b	Block 2 a	Block 2 b
Test theory (PSBE2-06) 5EC	Psychology in the workplace (PSBE2-03) 5 EC	Social environment and behaviour (PSBE2-04) 5 EC	Theory of science (PSBE2-05) 5 EC
Cognitive psychology (PSBE2-23)* 5 EC	Clinical psychology (PSBE2-22) 5 EC	Research methods: theory and ethics (PSBE2-08) 5 EC	
Introduction to clinical neuropsychology (PSBE2-24)* 5 EC			
Statistics II (PSBE2-07) 5 EC		Research practicum (PSBE2-09) 5 EC	
Communication and diagnostic skills (PSBE2-11) 5 EC		Statistics III (PSBE2-12) 5 EC	
Academic fields (BE2-14) 5 EC			

* For your second year you must choose BE2-23 or/and BE2-24. During your third year you can follow the other course.

12 The Third year

Coordinator: dr. K.E. Keizer, phone: 050 363 6461

Bachelor thesis coordinator: dr. H.J.E. Greijdanus, phone: 050 363 8299

12.1 Aims of the third year

The aims of the third year are:

- 1 the preparation for the master in psychology, by differentiation courses,
- 2 concluding the academic bachelor in psychology with a bachelors thesis,
- 3 offering minor and differentiation courses for broadening and deepening.

12.2 Programme

The programme of the third year has the following parts:

- A minor package of 2x15 or 30 EC
- A differentiation package of 20 or 15 EC
- A bachelors thesis of 10 or 15 EC

12.3 The minor package

To fulfill the obligations of the minor package there are a few options:

- 1 The university minor: a package of courses from other faculties, see the website www.rug.nl/minor.
- 2 Free minor: a minor package of your own choice. For actual information see the minor on Student Portal.

Free minor package requirements:

- university bachelor courses
- no propaedeutic psychology courses
- maximum 10 EC propaedeutic non-psychology courses
- no beginners courses in a language
- no courses that are part of the obligatory 1^e and 2^e year courses.

Potentially, a bachelor internship (PSB3E-SI) of 5 EC, to be organised and arranged by the student, can be done in semester 1b of year 3.

12.4 The differentiation package

Differentiation courses are listed below with a code containing the following letter combinations – IO (Industrial and organisational psychology, used to be AOP), CP (cognitive and physiological psychology), CN (Clinical neuropsychology), CP (Clinical psychology), OP (Developmental psychology), and/or SP (Social Psychology).

12.5 The Bachelor thesis

The Bachelor thesis is a practical for scientific research. The thesis is conducted in small groups, but the product, the thesis is an individual research report according to the standard (APA-format). The thesis may be started at the beginning of each semester. When during your thesis you want to change from a 10 EC to a 15 EC thesis or vice versa, you need to get approval from the supervising teacher

For students participating in the Honours College or Excellence programme, PSB3E-BT10 or PSB3E-BT15 is replaced by PSB3E-BTHO. PSB3E-BTHO is a practicum of 15 EC with a written report with a total workload of 420 hours;

12.6 The list of courses in the third year

Courses sorted to differentiation route.

All differentiation courses may serve as a differentiation course or as a minor course.

block	code	course	EC
Differentiation courses			
<i>Work, Organizational and Personnel Psychology</i>			
1a	PSB3E-IO04	Current topics in organisational psychology	5
1a	PSB3E-IO11	Sport and performance psychology	5
2a	PSB3E-IO07	Organisational change	5
2	PSB3E-IO010	Dynamic skills in groups	7,5
2b	PSB3E-IO03	Personnel psychology	5
<i>Cognitive Psychology and Psychophysiology</i>			
2a	PSB3E-CP02	Cognition and attention	5
2a	PSB3E-CP04	Human factors	5
1b	PSB3E-CP07	Perception	5
2b	PSB3E-CP06	Cognitive neuroscience	5
<i>Clinical Neuropsychology</i>			
2a	PSB3E-CN01	Clinical neuropsychology	5
2a	PSB3E-CN04	School neuropsychology: Mind, brain and education	5
1b	PSB3E-CN05	Gerontology	5
2b	PSB3E-CN03	Developmental neuropsychology	5
<i>Clinical Psychology</i>			
1a	PSB3E-KP01	Psychopathology: symptoms, classification and diagnosis	5
2a	PSB3E-KP06	Cognitive behavioural processes across disorders: a trans-diagnostic approach	5
1b	PSB3E-KP07	Introduction to cognitive behavioural therapies	5
1b	PSB3E-KP02	Understanding psychopathology	5
2b	PSB3E-KP05	Diagnosis and assessment	5
<i>Developmental psychology</i>			
2a	PSB3E-CN02	School neuropsych.: Mind, Brain and education	5
<i>Applied Social Psychology</i>			
1a	PSB3E-SP01	Group dynamics	5
1a	PSB3E-SP03	The social psychology of communication	5
1a	PSB3E-SP05	Interpersonal relations	5
2a	PSB3E-SP02	Intergroup relations	5
2a	PSB3E-SP04	Social cognition and affect	5
1b	PSB3E-SP06	Consumer and economic psychology	5
1b	PSB3E-SP07	Social influence	5
2b	PSB3E-SP08	Mass psychology	5

Free differentiation courses

1a	PSB3E-M05	Controversies in psychology	5
1a	PSB3E-M15	Experimental skills	5
1a	PSB3E-M13	Deception in clinical settings	5
2a	PSB3E-M11	Programming for psychologists	5
1b	PSB3E-M06	Human error	5
1b	PSB3E-M09	Philosophy of psychology	5
1b	PSB3E-M14	Learning: theory and practice	5
1b	PSB3E-M16	Statistical solutions to research problems in psychology	5
1	PSB3E-M17	Teaching Skills	10
1/2	PSB3E-LT	Literature study	5
1/2	PSB3E-SI	Independent Societal Internship	5

Thesis

1/2	PSB3E-BT10	Bachelor thesis	10
1/2	PSB3E-BT15	Bachelor thesis	15

You can choose either the 10 or 15 EC Bachelor thesis. The 10 EC thesis is the regular one. The 15 EC thesis is primarily meant for those who have the ambition to become a researcher.

Honours Programme

Block	code	course	EC
Block 1a/b and 2a/b	PSBE3-HO7	Research internship II	7
Block 2a/2b	PSBE3-HO2	Theoretical Seminar	2

12.7 Year overview

1a	1b	2a	2b
Current topics in organisational psychology PSB3E-IO04		Organisational change PSB3E-IO07	Personnel Psychology PSB3E-IO03
Sport and performance psychology PSB3E-IO11			
	Perception PSB3E-CP07	Cognition and attention PSB3E-CP02	Cognitive neuroscience PSB3E-CP06
		Human factors PSB3E-CP04	
	Gerontology PSB3E-CN05	Clinical neuropsychology PSB3E-CN01	Developmental Neuropsychology PSB3E-CN03
	Understanding psychopathology PSB3E-KP02	School neuropsychology: mind, brain and education PSB3E-CN04	
Psychopathology: symptoms, classification and diagnosis PSB3E-KP01	Introduction to cognitive behavioural therapies PSB3E-KP07	Programming for psychologists PSB3E-M11	
	Statistical solutions to research problems in Psychology PSB3E-M16	Cognitive behavioural processes across disorders: a trans-diagnostic approach PSB3E-KP06	Diagnosis and assessment PSB3E-KP05
Group dynamics PSB3E-SP01	Learning: theory and practice PSB3E-M14	Dynamic skills in groups PSB3E-IO09	
The social psychology of communication PSB3E-SP03	Consumer and economic psychology PSB3E-SP06	Intergroup relations PSB3E-SP02	Mass psychology PSB3E-SP08
Controversies in psychology PSB3E-M05	Social influence PSB3E-SP07	Social cognition and affect PSB3E-SP04	Interpersonal relations PSB3E-SP05
Experimental skills PSB3E-M15	Human error PSB3E-M06		
Deception in clinical settings PSB3E-M13	Philosophy of psychology PSB3E-M09		
Independent societal project PSB3E-SI		Independent societal project PSB3E-SI	
Teaching Skills PSB3E-M17			
Literature study PSB3E-LT	Literature study PSB3E-LT	Literature study PSB3E-LT	Literature study PSB3E-LT
Bachelor thesis PSB3E-BT10 / PSB3E-BT15		Bachelor thesis PSB3E-BT10 / PSB3E-BT15	

Note. The bachelor's theses (PSBE3-BT10 and PSB3E-BT15) may start in Block 1a or Block 2a and continues through Block 1b or Block 2b, respectively.

For descriptions of each course, please visit our online course catalogue Ocasys:

www.rug.nl/ocasys

Here you can find course information on content, lecturers, literature and more.

Part III – Formal regulations

14. Teaching and Examination Regulations (OER) - Faculty

Faculty of Behavioural and Social Sciences Teaching and Examination Regulations (OER)

Bachelor's degree programme

for the Academic Year 2016-2017

Contents:

- 1 General provisions
- 2 Qualifications and admission
- 3 Content and structure of the degree programme
- 4 The propaedeutic phase of the degree programme
- 5 Study advice
- 6 Admission to the post-propaedeutic phase of the degree programme
- 7 The post-propaedeutic phase of the degree programme
- 8 Other specializations
- 9 Examinations
- 10 Final assessment
- 11 Study progress supervision
- 12 Transitional and final provisions

The Teaching and Examination Regulations set out the specific rights and obligations that apply to each degree programme taught at the University of Groningen, for both students and the degree programme.

The University-wide section of the Student Charter sets out the rights and obligations that apply to all students.

These Regulations were decreed by the Board of the Faculty of Behavioural and Social Sciences on the 26th of May 2016 and approved by the Faculty Council where required on the 26th of April 2016.

SECTION 1 GENERAL PROVISIONS

Article 1.1 Applicability

1. These Regulations for academic year 2016-2017 apply to the teaching, examinations and final assessment of the Bachelor's degree programme of the English taught programme in Psychology (CROHO 56604), hereinafter referred to as **the degree programme**, and to all students enrolled in this degree programme.
2. The degree programme is provided by the Faculty of Behavioural and Social Sciences of the University of Groningen, hereinafter referred to as **the Faculty**.
3. These Teaching and Examination Regulations also apply to students of other degree programmes, faculties or institutes of higher education, insofar as they follow course units in one of the degree programmes (including Minors) offered by the Faculty to which these Regulations apply.
4. Course units or Minors that students of the degree programme as referred to in Article 1.1.1 follow in other degree programmes or at other faculties or institutes of higher education are subject to the Teaching and Examination Regulations of that programme, faculty or institute.
5. These Regulations also apply to students enrolled in the degree programme for the purpose of following a Pre-Master's programme as referred to in Article 8.7.1.

Article 1.2 Definitions

The following definitions apply to these Regulations:

- a. The Act: the Higher Education and Research Act (WHW; *Wet op het hoger onderwijs en wetenschappelijk onderzoek*)
- b. Student: a person registered at the University for the purpose of taking course units and/or examinations leading to the conferral of a university degree
- c. Degree programme: the Bachelor's degree programme referred to in Article 1.1 of these Regulations, comprising a coherent set of course units
- d. Course unit: a syllabus unit or other part of the degree programme within the meaning of Article 7.3 of the Act, included in OCASYS
- e. OCASYS: the University of Groningen's online course catalogue
- f. ECTS credit point: a credit point within the meaning of Article 7.4 of the Act. The student workload of each course unit is expressed in ECTS credit points, whereby 1 ECTS is equivalent to a student workload of 28 hours
- g. Propaedeutic phase: the first 60 ECTS credit points of the formal Bachelor's degree programme as defined in Article 7.8 of the Act
- h. Post-propaedeutic phase: the part of the Bachelor's degree programme following the propaedeutic phase

- i. Study progress overview: a written overview of study results and their ECTS credit points, which is sent to students by e-mail
- j. Preliminary study advice: a written overview of study results accompanied by a preliminary study advice, which is issued to students halfway through the academic year
- k. Definitive study advice: a study advice issued at the end of the academic year, which can be either negative, provisionally positive or positive, in accordance with Article 7.8b.1 of the Act
- l. Binding (negative) study advice: a negative study advice that is binding for the student in question and which means that the student may not continue with the degree programme, in accordance with Article 7.8b.3 of the Act
- m. Major: all compulsory course units in the propaedeutic and post-propaedeutic phases
- n. Minor slot: the space available for students to specialize within the degree programme
- o. Minor: a coherent set of course units that can be followed in the Minor slot
- p. University Minor: a broadening Minor that students can follow either at their own or a different Faculty
- q. Personal Minor: a broadening or deepening Minor that students can compile themselves and follow either at their own or a different Faculty
- r. Test or examination: a test of the knowledge, understanding and skills of students, including an assessment of the results
- s. Final assessment: the final assessment for the Bachelor's degree which is considered to be passed if all the requirements of the entire Bachelor's degree programme have been satisfied
- t. Academic year: the period of time that starts on 1 September and ends on 31 August of the following year
- u. Semester: part of the academic year, either starting on 1 September and ending on a date to be determined by the Board of the University, or starting on a date determined by the Board of the University and ending on 31 August
- v. Practical: a practical exercise, as referred to in Article 7.13 of the Act, in one of the following forms:
 - a thesis
 - a written assignment, paper or draft
 - a research assignment
 - participation in fieldwork or an excursion
 - completion of a placement
 - participation in another educational activity designed to teach certain skills
- w. Board of Examiners: an independent body with the duties and powers as set out in Articles 7.11, 7.12, 7.12b and 7.12c of the Act, including assessing whether the requirements of the final assessment have been met
- x. Admissions Board: the board that has decision-making powers in matters concerning admission to the degree programme on behalf of the Faculty Board
- y. Examiner: a person appointed by the Board of Examiners to set examinations and determine their results
- z. VWO diploma: pre-university certificate in accordance with Article 13.1 of the Secondary Education Act or Article 7 of the Secondary Education Act BES

- aa. Programme committee: the advisory body that fulfils the duties referred to in Article 9.18 of the Act.
- bb. Regular student: a student who is not a part-time, Minor or non-degree exchange student
- cc. Matching: matching activities and degree programme advice in accordance with Article 7.31a ff. of the Act.

All other terms will have the meaning that the Act ascribes to them.

SECTION 2 QUALIFICATIONS AND ADMISSION

Article 2.1 Admission to the programme

A VWO diploma (with any profile) or equivalent prior degree grants admission to the degree programme.

Article 2.2 Admission to the programme based on a HBO propedeutic certificate

Holders of a propaedeutic certificate from the HBO Bachelor's programme will be granted admission to the degree programme after having demonstrated sufficient knowledge at VWO final examination level of the following subjects, in accordance with the entry requirements for VWO graduates:

- Mathematics
- English

Article 2.3 Language requirement for foreign certificates

Not applicable.

Article 2.4 Admission to the degree programme on the basis of an entrance examination

1. Students who do not satisfy the admission requirements set out in Articles 2.1 and 2.2 may participate in an entrance examination in accordance with Article 7.29 of the Act. The Admissions Board is responsible for organizing this examination.
2. Students who wish to take the entrance examination must be aged 21 or over on the date on which the examination is held.. An exception to the age requirement may be made if the student in question has gained a certificate abroad that would grant admission to a university degree programme in his/her home country, or if the student has the status of refugee and for this reason is unable to present a degree certificate.
3. The entrance examination refers to the following subjects at VWO level:
Mathematics, English and Biology

The provisions of Article 2.3 apply.

4. A successfully completed entrance examination will grant admission to the University of Groningen degree programme for which it was taken for the duration of two academic years after the date the examination was taken.

Article 2.5 Admissions Board

1. The Admissions Board has the power to take decisions on behalf of the Faculty Board in matters concerning admission to the degree programme.
2. The Admissions Board consists of:
 - one member, also the chairperson, selected from the professors who teach the degree programme
 - at least two members selected from the other academic staff who teach the degree programme.
3. The study advisor for the degree programme (or an equivalent member of faculty staff) will be an advisory member and also secretary.
4. The selection will be made by the Faculty Board, which will also set out the admissions procedure.

Article 2.6 Intake date and application dates

1. There is one intake date per academic year, namely 1 September of each year.
2. In addition to this intake date, there are several application dates (1 November, 1 February, 1 April) on which registration may take place upon the approval of the Faculty Board.

Article 2.7 Matching

1. Prospective students are required to attend matching activities, where they will be issued with a degree programme advice.
2. The stipulations in the University of Groningen Regulations for Registration and Tuition Fees (RIC) and the Faculty matching procedure apply.

SECTION 3 CONTENT AND STRUCTURE OF THE DEGREE PROGRAMME

Article 3.1 Aims and learning outcomes of the degree programme

The aims and learning outcomes of the degree programme are set out in the appendix:

Appendix 1 Psychology;

hereinafter referred to as 'the appendix'.

Article 3.2 Type of degree programme

The degree programme in Psychology is a full time programme.

Article 3.3 Language of instruction

The language of instruction and examination in the degree programme is in English

Article 3.4 Student workload

1. The degree programme has a student workload of 180 ECTS credit points.
2. The propaedeutic phase has a student workload of 60 ECTS credit points.
3. The student workload is expressed in whole ECTS credit points.

Article 3.5 Conditions for awarding a University of Groningen degree

Students can only be awarded a Bachelor's degree for the degree programme if at least half of the programme was followed at the University of Groningen during the student's period of registration as a student at the University of Groningen.

Article 3.6 Contact hours

1. The propaedeutic phase of the degree programme comprises a minimum of 480 contact hours a year.
2. The post-propaedeutic phase of the degree programme comprises a minimum of 280 contact hours a year
3. The structure of the contact hours is set out in OCASYS.

Article 3.7 Organization and examinations of the degree programme

1. The following final assessments may be taken:
 - a. the propaedeutic assessment
 - b. the Bachelor's assessment.
2. The degree programme is divided into a propaedeutic phase and a post-propaedeutic phase.

Article 3.8 Participation in course units

1. Students may participate in course units of the degree programme if they register in good time via ProgRESS WWW (ProgressWWW.nl/Rug).
2. The maximum number of students for each course unit is listed in OCASYS.
3. Admission to course units with limited capacity is arranged according to the order of registration. Students who are registered for the degree programme will be given priority for the course units in their Major (or Minor).

SECTION 4 THE PROPAEDEUTIC PHASE OF THE DEGREE PROGRAMME**Article 4.1 Structure of the propaedeutic phase**

The course units in the propaedeutic phase, the related student workload and, if applicable, the related practicals are set out in the Appendix.

Article 4.2 Exemptions

1. At a student's request, the Board of Examiners, having discussed the matter with the examiner in question, may grant exemption from an examination on the basis of results earned previously (possibly elsewhere) on condition that the student:
 - a. has completed part of a university or higher vocational degree in the Netherlands or abroad that is equivalent in content and level
 - b. can demonstrate by work experience that he/she has sufficient knowledge and skills with respect to the course unit in question.
2. The stipulations of Article 3.5 apply to exemptions.
3. The validity period of exemptions granted for course units or parts thereof is identical to that for examination results.

SECTION 5 STUDY ADVICE

Article 5.1 Preliminary study advice

1. Halfway through the first semester of the first year of registration in the propaedeutic phase of the degree programme, students will receive a study progress overview specifying the student workload realized thus far.
2. Students will receive a written preliminary study advice as soon as possible after the first semester, and in any case before 1 March.
3. The preliminary study advice should be considered as a warning if there is a question of insufficient study progress, giving students the chance to improve their performance.
4. If the study progress is insufficient to such an extent that the student cannot reasonably be expected to satisfy the conditions for receiving a positive (or provisionally positive) study advice as listed in Articles 5.2.2 a and b, he or she will be invited to a meeting with the study advisor. The aim of the meeting is to discuss the student's study habits, to reassess the choice of degree programme, and if necessary to refer him or her to a different degree programme.

Article 5.2 Definitive study advice

1. Students must earn at least 45 ECTS credit points in their first year of registration in the propaedeutic phase of the degree programme. This threshold is known as the BSA threshold.
2. A definitive study advice is issued at the end of the first year of study, by 31 July at the latest. This can be either:
 - a. positive, for students who have successfully completed the propaedeutic programme
 - b. provisionally positive, for students who have earned at least 45 ECTS in the propaedeutic programme. This advice is accompanied by the condition that the propaedeutic phase must be successfully completed by the end of the second year of study (P-in-2)
 - c. negative, for students who have earned fewer than 45 ECTS of the propaedeutic programme. This study advice is binding on students (BSA) in accordance with Article 7.8b.3 of the Act.
3. In the event that the preliminary study results are insufficient to such an extent that the student cannot be reasonably expected to pass the 45 ECTS threshold by the end of his/her first year of study, a binding (negative) study advice may be issued subsequently to the preliminary study advice as referred to in Article 5.1 before the end of the academic year. This may also be at the request of the student. The procedure described in Article 5.5 will apply.

4. Students who were issued a provisionally positive study advice in accordance with Article 5.2.2b will be assessed at the end of the second year of registration in the degree programme, and by 31 July at the latest, to see whether they satisfy the requirements for a positive study advice.
 - a. If the student now satisfies the requirements for the propaedeutic certificate (P-in-2), the provisionally positive study advice will be converted into a definitive positive advice.
 - b. If the student still does not satisfy the requirements for the propaedeutic certificate (no P-in-2), this means that the conditions of the provisionally positive study advice have not been satisfied. The provisionally positive advice will therefore lapse and be converted into a negative study advice, which is binding on the student.
5. The Faculty Board will take extraordinary circumstances into account in its decision about which study advice to issue in the first year of registration, as well as in the assessment of the provisionally positive study advice in the second year of registration. Extraordinary circumstances may include:
 - a. personal circumstances as referred to in Article 5.4, as well as
 - b. recognized committee positions in the second year of registration on the grounds of a provisionally positive advice.

Article 5.3 Exceptions to the definitive study advice

Multiple degree programmes at the University of Groningen

1. Students who are registered for the propaedeutic phase of 2 or more University of Groningen degree programmes in their first year of registration, and by the end of the year satisfy the BSA threshold as referred to in Article 5.2.1 for one degree programme, will not have to satisfy the BSA threshold for the other programme(s) in that year. Once a student has successfully completed the propaedeutic phase of one degree programme, he or she is exempt from the BSA requirements for all other programmes.

Propaedeutic certificate previously gained elsewhere

2. Students who have already passed the propaedeutic phase of a degree programme at the University of Groningen or another Dutch university, or (for degree programmes that do not issue propaedeutic certificates) in the opinion of the Board of Examiners have earned 60 ECTS credit points in their first year of study, will not fall under the BSA system for the degree programme for which they enrol in the propaedeutic phase.

Deregistration before 1 February

3. No definitive study advice will be issued to students who submit a request for deregistration before or as of 1 February of the first year of registration for the propaedeutic phase of the degree programme. The procedure set out in Article 5.1 will apply again to students who

reregister in a subsequent academic year. The BSA regulations for the academic year in which they reregister will then apply.

Deregistration before 1 February + registration as of 1 February

4. Article 5.2 applies in full to students who deregister from a degree programme before 1 February and register for a degree programme in the same degree programme cluster, as of 1 February of the same academic year.

Registration as of 1 February

5. An adapted BSA threshold will apply to students who register for a University of Groningen Bachelor's degree programme as of 1 February and have not previously been registered as students in the same academic year. These students must have earned 20 ECTS in the propaedeutic phase of the degree by the end of the second semester of the first Academic Year of registration. The propaedeutic phase must have been completed by the end of the second Academic Year of registration (P-in-2). In all other cases, the provisions of Article 5.2 will apply *mutatis mutandis*.

Article 5.4 Personal circumstances

1. When deciding whether to issue a binding (negative) study advice, the Faculty Board will take a student's personal circumstances into account at that student's request.
The evaluation of personal circumstances will also take into account the student's study behaviour, the agreements made and/or the study plan drawn up in consultation with the study advisor, when the personal circumstances were reported and the study results achieved by the end of the first year of study.
2. Students must report personal circumstances to the study advisor as soon as possible in order to ensure optimum support. The Faculty Board, or the Faculty BSA Committee on its behalf, will make a decision in response to a student's request for an adapted BSA threshold. Students must also report to the study advisor as soon as possible if they are unable to complete the study plan drawn up in consultation with the study advisor and based on the original or adapted BSA threshold.
3. Students who fail to pass the BSA threshold by the end of the first year of the propaedeutic phase due to circumstances as referred to in Article 5.4.1, but who do satisfy the adapted threshold referred to in Article 5.4.2, will be issued a provisionally positive study advice.
4. Students who are issued a provisionally positive study advice will be assessed at the end of the second year of registration in the degree programme to see whether they satisfy the requirements for a positive study advice.
 - a. The provisionally positive study advice will be converted into a definitive positive study advice if:
 1. the propaedeutic phase has been successfully completed (P-in-2)

2. as a result of personal circumstances in the second year of study the student has not successfully completed the propaedeutic phase by the end of the second year of study, but has satisfied the adapted BSA threshold agreed upon. The provisions of Article 5.4.1 will apply *mutatis mutandis*.
 - b. The provisionally positive study advice will be converted into a negative study advice, which is binding on the student (BSA), if the student has not successfully completed the propaedeutic phase by the end of the second year of study, and has also failed to pass the adapted BSA threshold for the second year of study, if one was agreed upon.
5. Circumstances as referred to in Article 5.4.1 do not automatically lead to a successful application for a grant from the Graduation Fund.

Article 5.5 Procedure for issuing a definitive study advice

1. The definitive study advice is issued by the Faculty Board on behalf of the Board of the University. The decision will also state the applicable safeguards of legal rights.
2. Before a binding (negative) study advice is issued, students will receive notice of the intention to issue one, after which they will be given the opportunity to put their case to the Faculty Board or its representative.

Article 5.6 Consequences of a binding (negative) study advice

1. Students who have received a binding (negative) study advice may not register for the degree programme, for a period of 2 years from 1 September of the next academic year.
2. Students who have been issued a binding (negative) study advice are not permitted to follow course units in this degree programme via a different degree programme or educational institution in order to avoid the consequences of their binding (negative) study advice. No exemptions will be granted for course units completed in this way, nor will such completed course units be recognized within the framework of the degree programme in any other way.

SECTION 6

ADMISSION TO THE POST-PROPAEDEUTIC PHASE OF THE DEGREE PROGRAMME

Article 6.1 Criteria for admission to the post-propaedeutic phase

1. Holders of a propaedeutic certificate will be admitted to the post-propaedeutic phase of the degree programme.

2. Notwithstanding the provisions of Article 6.1.1, students who have earned at least 45 ECTS in the first year of the propaedeutic phase, and/or have been issued a provisionally positive study advice, can be provisionally admitted to the post-propaedeutic phase.
3. Provisional admission does not apply to the Minor of the degree programme – for this, the propaedeutic certificate is required.
4. Provisional admission to the post-propaedeutic phase will lapse if the student has not passed the propaedeutic assessment by the end of the second year of registration. Any post-propaedeutic course units passed will remain valid.
5. Provisional admission as set out in Article 6.1.2 only applies to course units of the first year of the post-propaedeutic phase (i.e. the second year of the Bachelor's degree programme). To participate in course units of the second year of the post-propaedeutic phase (i.e. the third year of the Bachelor's programme), the student must have passed the final assessment of the propaedeutic phase.

Article 6.2 Admission to the post-propaedeutic phase: hardship clause

The Board of Examiners may deviate from the stipulations of Article 6.1 in situations where changes to the curriculum or educational force majeure would demonstrably lead to a situation of unfairness of an overriding nature. This is only possible in unique personal circumstances that are so unusual that admission cannot in all reasonableness be denied.

Article 6.3 Study plan

1. All students who have been issued a provisionally positive study advice as referred to in section 5 with 50 or less ECTS or an adjusted BSA are expected to draw up a study plan in consultation with their study advisor, comprising at least the following:
 - a. the propaedeutic course units that have not yet been passed with a related time line
 - b. the post-propaedeutic first-year course units that may be followed in addition to the course units listed under a.
2. Students as meant in Article 6.3.1 must have visited the study advisor before the start of the second block of the first semester in order to be able to register for courses.

SECTION 7 THE POST-PROPAEDEUTIC PHASE OF THE DEGREE PROGRAMME

Article 7.1 Structure of the post-propaedeutic phase

1. The course units in the post-propaedeutic phase, the related student workload and, if applicable, the related practicals are set out in the Appendix.
2. Students can fill their Minor slot with the following components:
 - a placement/internship
 - a study period at a university abroad
 - a broadening or deepening Minor, comprising course units from outside their own Major (further details to be provided in the Appendix)
3. All course units and their modes of instruction are listed in the digital University course catalogue OCASYS.

Article 7.2 Replacements and electives followed elsewhere

1. Following a substantiated request by a student, the Board of Examiners may grant permission to:
 - a. replace a course unit in the examination programme with another course unit offered by the University of Groningen or another university in the Netherlands or abroad that dovetails well with the degree programme, or
 - b. to use one or more course units followed at the University of Groningen or another university in the Netherlands or abroad as electives in the degree programme.
2. When assessing such a request, the Board of Examiners will always evaluate the coherence of the set of course units (or parts thereof) and the level of the course units followed.

SECTION 8 OTHER PROGRAMMES

A. Minor

Article 8.1 Minor

1. The Minor slot can be filled using any of the options listed in Article 7.1.2.
2. Students can choose between:
 - a) a University Minor
 - b) a personal Minor.

Article 8.2 University Minor

1. A University Minor is a coherent set of broadening course units that students can follow either at their own or a different Faculty.
2. Students who choose to fill their Minor slot with a University Minor do not need explicit permission from the Board of Examiners.

Article 8.3 Personal Minor

1. A personal Minor is a coherent set of broadening or deepening course units that students can compile themselves and follow either at their own or a different Faculty.
2. Personal Minors must be presented to the Board of Examiners in advance for approval.

Article 8.4 Authority of the Board of Examiners with regard to Minors

1. Students must present their choice of Minor to the Board of Examiners of their own degree programme for approval, except if they choose a University Minor in accordance with Article 8.2.2.
2. Minors followed in other degree programmes or at other faculties or institutes of higher education are subject to the authority of the Board of Examiners of the degree programme that sets the relevant examinations.
3. Minors in the degree programme followed by students of other degree programmes, faculties or institutes of higher education are subject to the authority of the Board of Examiners of the degree programme.
4. A responsible Board of Examiners will be assigned in the event of interfaculty University Minors.

B. Honours programme**Article 8.6 Bachelor's Honours programme**

1. The Faculty participates in the Bachelor's Honours programme organized by the University of Groningen Honours College. The Bachelor's Honours Programme does not form part of the regular Bachelor's curriculum.
2. Students admitted to one of the Bachelor's degree programmes offered by the Faculty can participate in the Bachelor's Honours programme if they are selected by the Dean of the University of Groningen Honours College. Please consult the Teaching and Examination Regulations of the University of Groningen Honours College for the selection procedure.
3. The Bachelor's Honours programme has a total student workload of 45 ECTS credit points, divided over the three years of the Bachelor's programme.
The Bachelor's Honours programme, including the deepening Faculty part, is subject to the Teaching and Examination Regulations of the University of Groningen Honours College.
4.
 - a. The Honours programme does not form part of the regular Bachelor's curriculum. The results and marks do not count towards the awarding of an honours predicate for the Bachelor's programme.
 - b. The Diploma Supplement that accompanies the Bachelor's degree certificate will also list the results gained in the Bachelor's Honours programme.

C. Pre-Master's programmes**Article 8.7 Pre-Master's programmes**

1. The Faculty offers Pre-Master's programmes with student workloads of 60 ECTS credit points to facilitate entry into the Master's degree programmes in Psychology and Sociology (see Appendix 1).
2. Students who enrol in the Pre-Master's programme in Psychology are registered in the Bachelor's degree programme in Psychology, those who enrol in the Pre-Master's programme in Sociology are registered in the Bachelor's degree programme in Sociology.
3. The Admissions Board of the desired Master's degree programme will decide whether students are admitted to the Pre-Master's programme.

Article 9.4 Examination frequency and periods

1. There will be an opportunity to sit the examinations for the course units listed in the Appendix at least twice in each academic year.
2. The periods in which examinations can be sat are listed in the Student Handbook and/or OCASYS. Partial exams can also be taken outside the period indicated.
3. Notwithstanding the provisions of Article 9.3.1, alternative regulations apply to some course units. The Appendix sets out when this is the case.
4. Notwithstanding the provisions of Article 9.3.1, there will be only one opportunity in a certain year to take the examination for non-compulsory course units not taught in that year.
5. Examinations for course units that are part of a final propaedeutic or Bachelor's assessment as referred to in Article 10.1 may not be taken again.

Article 9.5 Assessment of placement/internship or research assignment

The assessment of a placement/internship or research assignment will be conducted by the on-site supervisor and the original commissioner, who will be appointed as examiners by the Board of Examiners.

Article 9.6 Bachelor's thesis

1. A Bachelor's thesis can in principle only be used for one University of Groningen degree programme. Full or partial exemptions for a degree programme's thesis may be granted by the Board of Examiners based on a Bachelor's thesis written for another degree programme.
2. More detailed regulations on the design, content, time frame and assessment of the thesis can be found in the Regulations for Bachelor's and Master's theses, which form part of these Teaching and Examination Regulations.
3. Article 10.1.7 on the storage period for theses applies.

Article 9.7 Form of examinations

1. Examinations will be taken in the manner stated in OCASYS.
2. At the student's request, the Board of Examiners may allow an examination to be taken in a form different from that stated above.
3. A mock version of each written examination, including an answer key, will be made available,

which should be representative of the form, content, and level, as well as indicative of the size of the actual examination .

Article 9.8 Request for additional resit

1. Students may submit a request for an additional resit to the Board of Examiners.
2. Such a request may be granted if the student in question failed the relevant exam due to extraordinary circumstances and if not granting the request for an additional resit would result in unacceptable study delay.

Article 9.9 Board of Examiners responsible for electives taken at other degree programmes

1. A request to take an elective at another degree programme must be approved by the Board of Examiners of the student's own degree programme.
2. The Board of Examiners of the other degree programme is authorized to set and assess the examinations and decide upon requests for alternative exam regulations. Article 9.10.2 applies.

Article 9.10 Examinations and performance disabilities

1. Students with a performance disability will be given the opportunity to take examinations in a form that will compensate as far as possible for their individual disability. If necessary, the Board of Examiners will seek expert advice from a student counsellor of the Student Service Centre (SSC) before making a decision.
2. With regard to examinations for electives taken at other degree programmes by students with a performance disability, the Board of Examiners of the degree programme that sets the examination will comply with the facilities permitted by the Board of Examiners of the degree programme for which the student is registered.

Article 9.11 Oral examinations

1. Unless the Board of Examiners decides otherwise, an oral examination may only be taken by one student at a time.
2. Oral examinations are public, unless the Board of Examiners or the relevant examiner stipulates otherwise or the student objects to the public nature of the examination due to

extraordinary circumstances. A second examiner may attend the oral exam at the request of the student and/or the examiner.

Article 9.12 Marking of examinations and publication of marks

1. After an oral examination, the examiner will assess the examination immediately and provide the student with a statement upon their request. He or she will provide the Faculty's administration department with the necessary details for registration of the result in Progress.
2. The examiner will mark a written examination with open-ended questions within ten working days and an examination consisting exclusively of multiple choice questions within five working days of the day on which it was taken, and will provide the Faculty's administration department with the necessary details for registration of the result in Progress.
3. If an examination is taken in a form other than oral or written, the Board of Examiners will determine in advance how and when students will receive written confirmation of the result.
4. The written confirmation of the result of an examination will also inform the student of his right of inspection, as stipulated in Article 9.14.1, as well as his right to appeal.

Students can lodge an appeal against the results of an examination with the Central Portal for the Legal Protection of Student Rights (CLRS) within 6 weeks of the date on which the result was announced.

Article 9.13 Validity

1. Completed course units remain valid indefinitely.
2. Notwithstanding the provisions of Article 9.13.1, the Board of Examiners may decide to require a student to take a supplementary or substitute examination for a course unit taken more than six years previously before allowing that student to progress to the relevant examination.

Article 9.14 Right of inspection

1. On request, students have the right to inspect their marked work during a period of up to six weeks after the results of a written examination have been made known. Also on request, they will be provided with a copy of the work at cost price.
2. Within the time frame stipulated in Article 9.14.1, any participant in the examination may request that they be allowed to peruse the examination paper and the assessment criteria.
3. On their request, students will be provided with feedback about the correct exam answers, possibly organized in the form of a group perusal session. The examiner will announce in what form and where a perusal session will take place before the examination. This session will take place within one week from the publication of the exam results and if possible no later than four working days before the date of the resit. If the person concerned can show that

they were prevented by force majeure from attending at the indicated places and times, they will be offered another opportunity, if possible within the period stated in article 9.14.1.

Article 9.15 Board of Examiners and examiners

1. The Board of Examiners is the independent body that determines whether individual students have the knowledge, understanding and skills required to be awarded the degree.
2. The Faculty Board appoints the members of the Board of Examiners on the basis of their expertise in the field of the degree programme (or cluster of degree programmes) in question.
3. The Board of Examiners must comprise at least:
 - a. one member who is a lecturer in the degree programme; and
 - b. one member from outside the degree programme.
4. Members of the Faculty Board or other people who have financial responsibilities within the institution may not be appointed as members of the Board of Examiners.
5. The Board of Examiners will appoint examiners to set examinations and determine the results.
6. The Board of Examiners will set out the Rules and Regulations of the Board of Examiners.

Article 9.16 Cheating and plagiarism

1. **Cheating** is an act or omission by a student designed to partly or wholly hinder the forming of a correct assessment of his or her own or someone else's knowledge, understanding and skills.
2. **Cheating** also includes plagiarism, which is copying someone else's work or ideas without correct reference to the source.
3. **Cheating** also includes misinforming to require additional facilities and arrangements concerning exams, tests and participation in courses.
4. If a student cheats, the Board of Examiners may exclude that student from participation in one or more examinations or final assessments for a maximum of one year after discovery of the fraud, or impose him another suitable measure or sanction.
5. In serious cases of cheating, the Board of Examiners may propose to the Board of the University that the student's registration be definitively terminated.
6. The Board of Examiners will set out its course of action in the event of cheating in its Rules and Regulations.

Article 9.17 Invalid examination

In the event of irregularities with regard to an examination that are so serious that an accurate assessment of the examinee's knowledge, understanding and skills cannot be made, the Board of Examiners may declare the examination invalid for either an individual examinee or a group of examinees.

Article 9.18 Termination of registration (*Iudicium Abeundi*)

1. In cases of serious objectionable behaviour and/or remarks by a student, the Board of the University can in certain cases, and after an advice from the Board of Examiners or from the Faculty Board, decide to terminate the registration of this student, after having carefully assessed all the interests of the student and the institution and once it has been proven reasonable to assume that the student's behaviour and/or remarks prove him/her to be unsuitable for one or more of the professions for which he/she is being trained in his/her degree programme or for the practical preparation for that profession. In such cases the Faculty Board, the Board of Examiners and the Board of the University will follow the *Protocol Iudicium Abeundi* [protocol for termination of registration] as approved by the *Nederlandse Federatie van Universitaire Medische Centra* [Netherlands Federation of University Medical Centres] on 1 November 2010.
2. The stipulations in the University of Groningen Regulations for Registration and Tuition Fees apply.

Article 9.19 Registering for course units and exams

1. To be allowed to participate in a course unit, students have to register for it via ProgressWWW, before the start of the block in which the course unit is taught.
2. During the first five weeks of a block in which a course unit is taught, students who haven't yet registered may visit the student desk to get still enrolled in the course.
3. A student who is not registered for a course unit, can't take an exam of that unit course.
4. A student who is registered for a course unit is also registered for the exam of that course unit.
5. A student with an insufficient mark on the first attempt of an exam is automatically registered for the resit.
6. A student can register for a maximum of four course units from a programme in each block.
7. A student is allowed to take more than four course units, but needs to make a study planning with the study advisor and hand in the study planning at the student desk.

SECTION 10

FINAL ASSESSMENT

Article 10.1 Final assessment

1. The degree programme is concluded with a final assessment.
2.
 - a. On condition that the student's study programme has been approved, the Board of Examiners determines the result of the final assessment as soon as the student has passed all the required examinations, thereby acquiring the necessary academic training.
 - b. If a student exceeds the relevant deadlines for approval of the study programme referred to under a, the Board of Examiners may postpone his or her graduation date. This date may then be in the academic year following the year in which the last examination was passed.
3. Before the final assessment can be determined, the Board of Examiners may decide to test the student's knowledge of one or more course units or components of the degree programme, if and inasmuch as the marks for these course units provide a reason for doing so.
4. By determining the result of the final assessment, the Board of Examiners also commits itself to a speedy processing of the degree certificate ceremony.
5. If a student wishes to postpone the date of graduation due to extra examinations that still need to be taken, he or she must submit a request to this end to the Board of Examiners in good time.
6. The graduation date is the date on which the final assessment is passed, as determined by the Board of Examiners in accordance with the provisions of Article 10.1.2, and not the date on which the degree certificate is presented to the student.
7. The successfully passed final assessment as referred to in Article 10.1.1, and all assignments submitted within the framework of this assessment, will be kept on file by the Faculty Board for a period of at least 7 years.

Article 10.2 Degree certificate

1. Students will receive a certificate issued by the Board of Examiners as proof that they have passed the final assessment. Even if a student successfully completes more than one specialization within a degree programme, he or she will receive only one degree certificate.

2. The Board of Examiners will issue an International Diploma Supplement with each degree certificate.
3. If relevant, the results obtained in the Bachelor's Honours Programme will also be listed on the Diploma Supplement that accompanies the Bachelor's degree certificate.

Article 10.3 Degree

1. Those who have passed the examination are granted the degree 'Bachelor of Science'.
2. The degree awarded shall be registered on the degree certificate.

Article 10.4 Honours ('judicium')

1. The Board of Examiners shall determine whether or not the Bachelor's degree certificate will be awarded an honours predicate.
2. There are two types of honours predicates: 'Cum laude' and 'Summa cum laude'. The following conditions apply:
 - a) for 'Cum laude':
 - i. the mark for the bachelor thesis must be at least 8.0
 - ii. The weighted average (not rounded off) for all course units, excluding the thesis, within the examination programme approved by the Board of Examiners must be greater than or equal to 8.0
 - a) for 'Summa cum laude':
 - i. the mark for the bachelor thesis must be at least 9.0
 - ii. The weighted average (not rounded off) for all course units, excluding the thesis, within the examination programme approved by the Board of Examiners must be greater than or equal to 9.0
3. No honours as referred to in Article 10.4.2 are awarded if the student workload of the exemptions in ECTS credit points is more than half the total number of ECTS for the degree programme.
4. Honours as referred to in Article 10.4.2 may only be awarded if the examinations for all course units except one were taken only once. One course unit may be resat, and only one resit may be taken for this course unit.
5. Honours as referred to in Article 10.4.2 may only be awarded if no resit opportunity was used for the thesis.
6. Honours as referred to in Article 10.4.2 may only be awarded if no single course unit was awarded a mark less than 7.0.
7. No honours as referred to in Article 10.4.2 are awarded if a decision by the Board of Examiners has been taken to the effect that a student is no longer eligible for an honours

predicate because cheating/plagiarism has been detected.

8. In certain circumstances, the Board of Examiners may depart from the provisions set out in Articles 10.4.2-7.
9. Students who started the degree programme before 1 September 2013 continue to fall under the honours regulations that applied to them on 31 August 2013.

Article 10.5 Assessment plan

An assessment plan has been approved by the Faculty Board, comprising the following topics:

1. the learning outcomes of the degree programme
2. the course units of the degree programme and the learning outcomes of each course unit
3. the relationship between course units and learning outcomes
4. the assessment mode to be used and the test moments for each course unit
5. the test design and assessment procedures and assessment criteria used
6. the right of inspection
7. who is/are responsible for the implementation of the various components of the assessment policy
8. the method of regular evaluation.

SECTION 11 STUDY PROGRESS SUPERVISION

Article 11.1 Study progress administration

The Faculty Board registers individual study results for all students, and at least twice a year and on request provides students with an overview of their study results.

Article 11.2 Study progress supervision

The Faculty Board will organize the introduction and the study progress supervision for students enrolled in the degree programme, partly to promote their progress and also with a view to potential study options within and outside the degree programme.

SECTION 12 TRANSITIONAL AND FINAL PROVISIONS

Article 12.1 Amendments

1. Any amendments to these Regulations will, after consultation with – and where necessary upon the approval of – the Faculty Council, be confirmed by the Faculty Board in a separate decree.
2. Any amendments to these Regulations will not apply to the current academic year, unless it may reasonably be assumed that the amendment in question will not harm the interests of students.
3. In addition, an amendment may not influence any other decision concerning a student taken by the Board of Examiners under these Regulations to the disadvantage of students.

Article 12.2 Publication

1. The Faculty Board will duly publish these Regulations as well as any amendments to them.
2. Copies of these Teaching and Examination Regulations are available from the Faculty Office. These documents can also be found on the Faculty website via 'My University'.

Article 12.3 Date of commencement

These Regulations will take effect on the 1st of September 2016.

15. Teaching and Examination Regulations (OER) – Programme

Bachelor of Science Degree Programme in Psychology

Faculty of Behavioural and Social Sciences

2016 - 2017

Appendix: the programme

Paragraph 1 Aim of the programme and language of the courses

Article 1.1 Aim of the programme

The aim of the programme is to give the student:

- Knowledge and understanding of psychology, and psychological skills;
- General academic training;
- Preparation for the qualifications required for admission to the Master Degree Programme in Psychology at the University of Groningen.

Article 1.2 Language

The course units and exams are offered in the English language. Students enrolled in the English programme are allowed to the English exams only, but may formulate answers in Dutch in case of an essay exam. A Bachelor of Science Degree Programme in Psychology is offered in the Dutch language at our Faculty as well (see the course catalogue "Bachelor Programma Psychologie"). Assuming the language requirement is met, it is possible to request admission to the Dutch-language programme after obtaining the propaedeuse.

Paragraph 2 The propaedeutic phase of the programme

Article 2.1 Structure of the propaedeutic phase

The propaedeutic phase contains the following courses with a study load as indicated:

BE1-01	Introduction to psychology	5 EC
BE1-02	Social and cross-cultural psychology	5 EC
BE1-03	Developmental psychology	5 EC
BE1-04	Biopsychology	5 EC
BE1-05	Personality and individual differences	5 EC
BE1-08	Statistics IA	5 EC

BE1-09	Statistics IB	5 EC
BE1-17	Dialogue and group skills	5 EC
BE1-24	Introduction to research methods	7.5 EC
BE1-25	Academic skills	7.5 EC
BE1-26	Psychology: history and application	5 EC

Article 2.2 Propaedeutic practicals

1. The following propaedeutic courses contain, besides teaching in the form of lectures, a practicum in the form and size as indicated:

BE1-08	Exercises and assignments	14 hours
BE1-09	Exercises and assignments	14 hours
BE1-17	Exercises, assignments and papers	140 hours
BE1-24	Exercises, assignments and papers	145 hours
BE1-25	Exercises, assignments and papers	145 hours

The courses of this section are exclusively accessible for BSc-Psychology students. The examinations committee may make an exception based on a motivated and timely request (i.e. two weeks before the start) from a student of other BSc-degree programmes.

2. The examination of a course mentioned in this Article cannot be registered in Progress before the related practicum is successfully completed in the same academic year as, or in the academic year preceding, the examination of the course. Where practicals consist of clearly separated modules, these separate modules remain valid for the period of the current and the next academic year.
3. For the following courses the successful completion of the practicum is considered equivalent to passing the examination of the course: BE1-17, and BE1-25.

Article 2.3 Contact hours

The number of contact hours in the propaedeutic phase should be 12 hours per week. At four times ten weeks the total number of prescribed contact hours adds up to 480 per year, including exams and course response hours. The courses listed in article 2.1 contain the following amount of contact hours:

BE1-01	Introduction to psychology	40 h
BE1-02	Social and cross-cultural psychology	37 h
BE1-08	Statistics IA	53 h
BE1-03	Developmental psychology	25 h
BE1-09	Statistics IB	53 h
BE1-17	Dialogue and group skills	64 h
BE1-04	Biopsychology	44 h
BE1-05	Personality and individual differences	25 h
BE1-24	Introduction to research methods	62 h

BE1-25	Academic Skills	78 h
BE1-26	Psychology: history and application	25 h
Total		506 h

The contact hours can be specified as follows:

Lectures	220 h
Practicals	162 h
Exams/re-sits	34 h
Study coaching	90 h

Paragraph 3 The post-propaedeutic phase of the programme

Article 3.1 Structure of the post- propaedeutic phase

1. The post-propaedeutic phase contains:
 - a. Courses that belong to the Major 90 EC
 - b. Courses that belong to the Minor 30 EC
2. The Major contains the following components with a study load as indicated:
 - a. A compulsory component of 60 EC;
 - b. A differentiation component of 15 EC or of 20 EC (depending on the size of the bachelor thesis);
 - c. A bachelor thesis of 10 EC or of 15 EC
3. The Minor consists of the choice from one of the following options, composed of 30 or 2 x 15 EC:
 - a. A University Minor;
 - b. A Free-Choice Minor

Article 3.2 Compulsory component of the Major

1. The compulsory component of the Major contains the following courses with a study load as indicated:

BE2-03	Psychology in the workplace	5 EC
BE2-04	Social environment and behaviour	5 EC
BE2-05	Theory of science	5 EC
BE2-06	Test theory	5 EC
BE2-07	Statistics II	5 EC
BE2-08	Research methods: theory and ethics	5 EC
BE2-09	Research practicum**	5 EC
BE2-11	Communication and diagnostic skills	5 EC
BE2-12	Statistics III	5 EC
BE2-14	Academic fields	5 EC
BE2-22	Clinical psychology	5 EC
BE2-23	Cognitive psychology*	5 EC
BE2-24	Introduction to Clinical Neuropsychology*	5 EC

* Students must enrol in either Cognitive Psychology or Introduction to Clinical Neuropsychology as a compulsory part of their second year. Additionally they can choose for the other course during their third year.

** For students participating in the Honours College or Excellence programme, BE2-09 Research practicum is replaced by BE2-HO9 Honours Research practicum

2. The following courses mentioned in Article 3.2.1 contain, in addition to teaching in the form of lectures, a practicum in the form and size as indicated:

BE2-07	Exercises and assignments	26 hours
BE2-09	Exercises, assignments and papers	140 hours
BE2-11	Exercises, assignments and papers	140 hours
BE2-12	Exercises and assignments	12 hours
BE2-14	Exercises, assignments and papers	140 hours

The courses of this section are exclusively accessible by BSc-Psychology students, with the exception of Statistics II and/or Statistics III which are accessible for students of Artificial Intelligence of the RuG. The examinations committee may make an exception based on a motivated and timely request from a student of other BSc-degree programmes.

3. The examination of a course mentioned in Article 3.2 paragraph 1 cannot be registered in Progress before the related practicum is successfully completed in the same academic year as, or in the academic year preceding, the examination of the course. Where practicals consist of clearly separated modules, these separate modules remain valid for the period of the current and the next academic year.
4. For the following courses the successful completion of the practicum is considered equivalent to passing the examination of the course: BE2-09, BE2-11 and BE2-14.

Article 3.3 Differentiation component of the Major

1. The differentiation component of the Major contains courses in six differentiation areas (1-6 below). At least 15 EC have to be chosen from all courses as listed in this Article section.

1. Work, Organizational and Personnel Psychology

PSB3E-IO03	Personnel psychology	5 EC
PSB3E-IO04	Current topics in organizational psychology	5 EC
PSB3E-IO07	Organisational change	5 EC
PSB3E-IO10	Dynamic skills in groups	10 EC
PSB3E-IO11	Sport and performance psychology	5 EC

2. Cognitive Psychology and Psychophysiology

PSB3E-CP02	Cognition and attention	5 EC
PSB3E-CP04	Human factors	5 EC
PSB3E-CP06	Cognitive neuroscience	5 EC
PSB3E-CP07	Perception	5 EC

3. Clinical Neuropsychology

PSB3E-CN01	Clinical neuropsychology	5 EC
PSB3E-CN03	Developmental neuropsychology	5 EC
PSB3E-CN04	School Neuropsychology: Mind, Brain & Education	5 EC
PSB3E-CN05	Gerontology	5 EC

4. Clinical Psychology

PSB3E-KP01	Psychopathology: symptoms, classification and diagnosis	5 EC
PSB3E-KP02	Understanding Psychopathology	5 EC
PSB3E-KP05	Diagnosis and assessment	5 EC
PSB3E-KP06	Cognitive behavioural processes across disorders: a trans-diagnostic approach	5 EC
PSB3E-KP07	Introduction to cognitive behavioural therapies	5 EC

5. Developmental Psychology

PSB3E-CN04	School Neuropsychology: Mind, Brain & Education	5 EC
------------	---	------

6. Applied Social Psychology

PSB3E-IO10	Dynamic skills in groups	10 EC
PSB3E-SP01	Group dynamics	5 EC
PSB3E-SP02	Intergroup relations	5 EC
PSB3E-SP03	The social psychology of communication	5 EC
PSB3E-SP04	Social cognition and affect	5 EC
PSB3E-SP05	Interpersonal relations	5 EC
PSB3E-SP06	Consumer and economic psychology	5 EC
PSB3E-SP07	Social influence	5 EC
PSB3E-SP08	Mass psychology	5 EC

Free differentiation courses

PSB3E-M05	Controversies in psychology	5 EC
PSB3E-M06	Human error	5 EC
PSB3E-M09	Philosophy of psychology	5 EC
PSB3E-M11	Programming for psychologists	5 EC
PSB3E-M13	Deception in clinical settings	5 EC
PSB3E-M14	Learning: theory and practice	5 EC
PSB3E-M15	Experimental skills	5 EC
PSB3E-M16	Statistical solutions to research problems in Psychology	5 EC
PSB3E-M17	Teaching skills	10 EC
PSB3E-LT	Literature study	1-5 EC
PSB3E-SI	Independent Societal Project	5 EC

2. The following course mentioned in this Article contain, in addition to teaching in the form of

lectures, a practicum in the form and size as indicated:

PSB3E-IO04	Exercises and assignments	60 hours
PSB3E-IO10	Exercises and assignments	280 hours
PSB3E-KP05	Exercises and assignments	140 hours
PSB3E-M11	Exercises and assignments	140 hours
PSB3E-M15	Exercises and assignments	140 hours
PSB3E-M17	Exercises and assignments	280 hours

The courses of this section, but not only these, are exclusively accessible for BSc-Psychology students. The examinations committee may make an exception based on a motivated and timely request from a student of other BSc-degree programmes.

3. The examination of a course mentioned in Article 3.2 paragraph 1 cannot be registered in Progress before the related practicum is successfully completed in the same academic year as, or the academic year preceding, the examination of the course.
4. For the following courses the successful completion of the practicum is considered equivalent to passing the examination of the course: PSB3E-M11, PSB3E-M15, PSB3E-M16.
5. Examinations of the courses listed in section 1 are taken in written form, with the exception of PSB3E-LT, which may also be examined orally upon decision of the examiner.

Article 3.4 Bachelor Thesis

1. The Bachelor Thesis (PSB3E-BT10) is a practicum of 10 EC with a written report with a total workload of 280 hours.
2. The Bachelor Thesis (PSB3E-BT15) is a practicum of 15 EC with a written report with a total workload of 420 hours;
3. A student performs the bachelor thesis according to section 1 or section 2 but not both.
4. For students participating in the Honours College or Excellence programme, PSB3E-BT10 or PSB3E-BT15 can be replaced by PSB3E-BTHO. PSB3E-BTHO is a practicum of 15 EC with a written report with a total workload of 420 hours;
5. For the following courses the successful completion of the practicum is considered equivalent to passing the examination: bachelor thesis (PSB3E-BT10/PSB3E-BT15/PSB3E-BTHO).
6. Further rules on form, content, timeline and grading of the Bachelor Thesis can be found in the Bachelor Thesis Manual and Bachelor Thesis Grading Form, which can both be found in the Bachelor Thesis course environment on Student Portal.

Article 3.5 The Minor

1. The University minor, as listed in article 3.1.3.a, may be selected from the University Minors offered at faculties of the University of Groningen, with a total study load of 30 EC. Minors offered by the degree programme in Psychology are excluded from this selection.
2. With the exception of students of the Bachelor Programmes Psychology, Sociology and Pedagogy, students of a Groningen University Bachelor Programme are admitted to the minor courses PSMIN01 Introduction to Psychological Theories and Applications, and PSMIN02 Research Instruments Critically Considered, provided they have completed the propaedeutic phase of their programme.
3. The Free-Choice Minor, as listed in article 3.1.3.b, may contain a choice of courses with a total study load of 30 or 2 times 15 EC (semester 1a and 1b of year 3), to be chosen from:
 - a. the courses offered by the Department of Psychology in its differentiation component or an equivalent course, and/or
 - b. other university bachelor programmes from the Netherlands or abroad, after approbation by the Examinations Committee.
 - c. Potentially, a social internship (PSB3E-SI) of 5 EC, to be organised and arranged by the student, can be done in semester 1b of year 3. This internship is only allowed for students in the Psychology programme.

Article 3.6 Equivalencies

The courses listed below under 'Current code' cannot be taken by students who have, in an earlier academic year, successfully completed the corresponding courses listed under 'Previous code'.

Previous code	Current code	Current name
PSB3E-IO06	PSB3E-IO11	Sport and performance psychology
PSBAM-AOP6	PSB3E-IO11	Sport and performance psychology

Article 3.7 The excellence programme

1. An academic excellence programme for talented students is offered in the post-propaedeutic phase. The academic excellence programme consists of the following courses with a study load as indicated:

BE2-HO1	Honours research seminar	2 EC
BE3-HO2	Honours theoretical seminar	2 EC
BE2-HO3	Honours thematic meetings	4 EC
BE2-HO6	Honours research internship I	5 EC
BE3-HO7	Honours research internship II	7 EC
2. The courses' load of a total of 20 EC is in addition to the regular post-propaedeutic programme of 120 EC. For students in the Excellence programme BE2-HO9 replaces the course BE2-09 in the regular post-propaedeutic programme. To receive a certificate the excellence programme should be completed in the third year.

3. The following courses mentioned in Article 3.7.1 contain a practicum in the form and size as indicated:

BE2-HO1	Exercises, assignments and papers	56 hours
BE3-HO2	Exercises, assignments and papers	56 hours
BE2-HO3	Exercises, assignments and papers	112 hours
BE2-HO6	Exercises, assignments and papers	140 hours
BE3-HO7	Exercises, assignments and papers	196 hours

4. The examination of a course mentioned in this Article cannot be taken before the related practicum is successfully completed in the same academic year as the examination of the course.
5. For the following courses, the successful completion of the practicum is considered equivalent to passing the examination: BE2-HO1, BE3-HO2, BE2-HO3, BE2-HO6, and BE3-HO7.
6. The courses BE2-HO1, BE2-HO3 and BE2-HO6 must be completed at the end of the first post-propaedeutic year. The courses BE3-HO2 and BE3-HO7 need to be completed at the end of the second post-propaedeutic year. No resits are offered.
7. Admissible to the excellence programme are those students who have completed the propaedeutic exam in Psychology in their first year of study. Admissible students can apply for a place in the programme by sending a letter of motivation, grade list, and the paper written for the course BE1-23 to the Programme coordinator. Selection for the programme will be based on these materials. Students who are admitted to the University honours programme are automatically admitted to the excellence programme.
8. Selected students follow all courses of the academic excellence programme mentioned in Article 3.7.1. All courses completed successfully are listed in the degree supplement.

Paragraph 4 Examination and exams in the degree programme

Article 4.1 Compulsory order of examinations

1.

Course	Condition
BE2-06 "Test theory"	BE1-08 or BE1-09 is passed
BE2-07 "Statistics II"	One of the courses BE1-08 and BE1-09 is passed, and the other is graded with minimally 5. The permission remains valid even if the course that was initially graded 5 is graded lower after the re-sit.
BE2-09* "Research practicum"	The courses BE1-08 and BE1-09 are passed, and the requirements for the BE2-07 practical have been met.
BE2-12 "Statistics III"	The course BE1-08 and BE1-09 are passed, and the requirements for the BE2-07 practical have been met.
B3E-BT10 or B3E-BT15 "Bachelor Thesis"	BE2-06, BE2-08, BE2-09* and one of the following courses: BE2-07 or BE2-12, are passed.

B3E-SI "Independent Societal Project"	Passing courses BE2-22, BE2-03, BE2-04, BE2-05, BE2-08, BE2-11, BE2-14 and one of the two following courses: BE2-23 or BE2-24.
B3E-M16 "Statistical solutions to research problems in psychology"	BE2-06 and BE2-12 are passed
B3E-M17 "Teaching Skills"	BE2-11 is passed
B3E-IO10 "Dynamic Skills in Groups"	BE1-17 is passed

* For students participating in the Honours College or Excellence Programme, BE2-09 is replaced by BE2-HO9 in article 4.1.c and 4.1.d

2. In addition to the criteria mentioned in Article 6.2 of the BSS Teaching and Examination Regulation: access to the post-propaedeutic phase of the programme for students without the propaedeutic certificate is restricted to the compulsory component of the major, as described in Article 3.2.
3. In addition to the criteria mentioned in Article 6.2 of the BSS Teaching and Examination Regulations: Students who started their studies in study year 2009-2010 or before are not allowed to participate in courses of the post-propaedeutic phase until the following requirements are met:
 - a. At least a course load of 45 EC, chosen from the courses mentioned in Article 2.1, has been successfully completed;
 - b. The courses BE1-01 and BE1-08 have been successfully completed.

Access to the post-propaedeutic phase of the programme is restricted to the compulsory component of the major, as described in Article 3.2.

Article 4.2 Frequency of practicals

1. The programme offers one opportunity per year for taking the practicals mentioned in this OER. There is no resit.
2. Unlike the regulations mentioned in paragraph 1, two opportunities per year are offered for taking the bachelor's thesis.

Paragraph 5 Admission

Article 5.1 Language

1. Students should be able to show that they have sufficient knowledge of the English language. The following qualifications are accepted as sufficient proof of mastery:
 - a. A preparatory scientific education degree, Dutch "VWO" or equivalent including the English language.
 - b. A TOEFL test outcome of greater than or equal to 237 (computer based) or greater than or equal to 580 (paper based) or greater than or equal to 92-93 (internet based).

- c. An IELTS test outcome greater than or equal to 6.5;
- d. A CAE (level C1) with grade A, B, or C.
- e. A CPE (level C2) with grade A, B, or C.
- f. English as a first language.
- g. A secondary or higher education diploma issued by an English-language institution.

16. Rules and Regulations

Of the Examinations Committee of Psychology for academic year 2016-2017 (d.d. 30 June 2016)

Article 1 – Applicability

These Rules and Regulations apply to the examinations provided by the Bachelor of Science degree programme in Psychology, hereinafter called 'the programme'.

Article 2 – Definitions

The following definitions apply to these Rules and Regulations:

- Faculty examination regulations: the Teaching and Examination Regulations for the programme, most recently updated on 26 May 2016;
- Programme examination regulations: the appendix of the Faculty examination regulations that consist of the regulations of the programme, most recently updated on 26 May 2016;
- Examinations Committee: the Examinations Committee for Psychology;
- Examinee: a person taking an examination or final assessment;
- Final assessment: the final assessment for the Bachelor's degree programme.

The other definitions shall have the meaning that the above mentioned Examination regulations or the Act ascribes to them.

Article 3 – Day-to-day affairs of the Examinations Committee

1. The chairperson and the secretary of the Examinations Committee are responsible for the day-to-day affairs of the Examinations Committee. They can be supported by an administrative secretary and advised by the programme's study advisor(s).
2. The decisions of the Examinations Committee or the examiner, respectively, are subject to an appeals procedure.

Article 4 – Decision to set an oral examination

With the permission of the examinee, an examiner may decide that a certain examination will be an oral examination.

Article 5 – Determining the results of the final assessment

1. If the Examinations Committee decides to instigate an investigation within the meaning of Article 10 section 3 of the Faculty Examination Regulations, the Examinations Committee will determine the result by a simple majority of votes.
2. If there is not a majority, then the examinee will be failed.
3. At least three members of the Examinations Committee, including the chairman or the secretary, must be involved in the determination of the result.

Article 6 – Awarding predicates

For students who started the programme before 1 September 2012 and were enrolled without any interruption, the following rules are applicable, as a departure from the rule in article 10.4 of the Faculty examination regulations:

1. The result of the final assessment may be awarded the predicate 'cum laude' or 'summa cum laude'. Cum laude will be awarded if the weighted unrounded grading average is 8 or more, and the thesis is graded with 8 or more, and no grade is below 7. For summa cum

laude the weighted unrounded grade averaged should be 9, or more, and the thesis grade should be 9 or more, and no grade is below 7. Only those grades will be taken into account that are part of the exam.

Note: when determining the predicate '(summa) cum laude' only those courses which constitute the degree programme will be considered. Examinees who have followed more courses than needed for the degree programme must when requesting a final assessment indicate clearly which courses qualify for the degree programme of 180 EC.

2. For the propaedeutic programme: no predicate will be awarded if less than 50 ECTS credits have been gained within the propaedeutic programme. For the post-propaedeutical phase: no predicate will be awarded if less than 90 ECTS have been gained within the post-propaedeutic programme. In individual cases the committee may decide otherwise on request.

Note: this may be possible when the candidate can proof that his/her performance on programme courses passed outside the programme in Groningen is of the highest quality

Article 7 – Times

1. Written examinations must be taken at the times set by the Examinations Committee in consultation with the relevant examiners. These times will be published before the start of the semester in question.
2. When determining the times as referred to in subsection 1, as far as possible no examinations will be planned concurrently.
3. Changes to a time as referred to in subsection 1 may only take place as a result of force majeure, for example the non-availability of the required examination hall.
4. Oral examinations will be taken at a time to be agreed between the examiner or examiners in question and the examinee.

Article 8 – Registration

1.
 - a. Examinees must register for a programme module and to take an examination.
 - b. Students may register for a maximum amount of 4 modules per block.
 - c. Only in specific cases a student with a well-reasoned request may obtain permission from the examinations committee to register for more than 4 modules per block, to be decided by the examinations committee.
2. For modules with a written (end-) exam the following rules apply: Registration for modules and the registration period is regulated in the Faculty Examination Regulations.
 - a. A student who fails the resit or does not attend it, has to register anew for the module to be admitted to the module and the exam(s) in the next academic year.
Note: the first exam is the first exam that is scheduled in an academic year. If this is the third exam for a student for that module, no automatic registering will take place, but the student has to reregister him/herself.
 - b. A student who wants to resit an exam that in a previous exam was graded with a "pass" grade, has to register at the Student Service Desk, ultimately four working days before the exam. If resitting a "pass" grade, the student has to retake all parts that the exam consist of, and this has to be done in the same academic year as the 'pass' grade was obtained.
Note if an exam consists, e.g., of a written test and an assignment, the student has to redo both the test and the assignment.
3. Examinees who are not registered for a module or for an examination may not take that module or examination. No grade will be awarded for such an examination.

4. a. Registration for a module and the registration period is regulated in the Faculty Examination Regulations.
b. In contravention to 4a: registration for practicals occurs at least ten working days before the start of the block in which the practical will be given. In individual cases the registration for a practical may be done later if necessitated by the temporal order of the admission procedure. Late registration is only possible with permission of the coordinator of the module.
c. For a literature exam registration occurs by sending an e-mail to the individual examiner of the exam in question, with a copy to the third-year's co-ordinator.
d. For the Social Internship / Research Internship a student has to contact the lecturer in question and the third-year's co-ordinator conform the procedure in the course catalogue.
e. For an oral examination registration occurs by a personal appointment with the individual examiner of the exam in question, with a copy to the third-year's co-ordinator.
5. For modules that have a practical according to applicable articles of the Programme examination regulations, where the practical is a condition for, or a part of, the examination, or is the examination, examinees have the obligation to end the registration in the case of non-attendance, not later than at the moment the possibility of registration closes. Students who do not comply will only be admitted at the following occasion of the module if there is sufficient capacity.
6. In exceptional circumstances, the Examinations Committee may depart from the provisions of the previous subsections with regard to the place and time of registration.
7. Registration for the propaedeutic examination will proceed automatically, as soon as all modules of the programme are finished successfully. The examinee will receive an invitation for the next possibility to receive the degree certificate.
8. Examinees are invited to register for the final examination when handing in the thesis. If or as soon as it is clear that the prerequisites of the final exam are fulfilled the examinations committee will notify in writing the examinee within 20 working days, mentioning the examination date and the date of the diploma presentation. The examinee will receive an invitation to attend at least five working days before the date of the diploma presentation.
9. An examinee who wants extend the date of the final assessment to complete additional modules before registering for the final exam, as stipulated in article 10.1 section 5 and section 6 of the Faculty Examinations regulations, has to notify the examination committee of this plan within a term of 10 working days after the moment that the result of this final module is published on Progress. Since additional modules are not part of the exam and therefore they will not be listed on the diploma supplement.

Article 9 – Nullifying declarations

An examination that is taken or a practical that is followed in the wrong order (see the order of modules set out in the Programme examination regulations) will be considered not to have been taken or followed. No grade will be awarded for that module.

Article 10 – Request for exemption

1. A request for exemption from the examination of a course must be submitted in writing to the Examinations Committee, in line with the relevant specifications which are available from the Education Office.
2. The Examinations Committee will make its decision within a month of receipt of the request. The person making the request will be informed of the decision in writing.

3. It is not possible to be exempted from the requirements of the Bachelor's thesis. This must be written within the framework of the programme and under the supervision of an examiner of the programme in accordance with the usual procedure as published in the Bachelor's thesis guide of the academic year in question.
4. An exemption expires if and as soon as the student afterwards takes the exam in the programme itself for the course where the exemption was granted for.
5. The examination committee does not grant an exemption for a course afterwards, if the student did take the exam for that course already at least once in the programme itself, irrespective the possible outcome of the exemption request.

Note: exemptions based on courses or modules from Universities of Applied Sciences will not be awarded.

Article 11 – Approval of courses for the personal minor

1. A request for approval of courses for the personal minor in accordance with various rules in article 8 of the Faculty examination regulations must be addressed to the Examinations Committee, in writing, using the appropriate form to be obtained at the Student Service Desk or from the website of the programme.
2. Approval may be obtained before the module(s) is/are to be followed. Approval of (already finished) modules will only be granted if these modules meet the requirements of valid free-choice minor modules: only a package with university modules that do not overlap with modules in the programme's propaedeutic or major phase, and that contains at most 10 EC of modules at propaedeutic level of a non-psychology programme or language courses, will be approved. For language courses only courses on the B2 end level or higher will be approved. In other cases 5 EC will be subtracted from the course load. English and Dutch courses are only approved if their level exceeds the entree level of the programme. Language courses of preceding educational programmes of a student will never be approved.
3. The examinations committee decides within a month after receiving the request, notifying the examinee in writing.
4. For modules outside the programme the results should be communicated to the Student Service Desk as soon as available in the form of the official result transcripts.
5. A renewed request for minor modules will (partially) not be recognized if a student already completed (in part) minor requirements by completing modules from a previous request. A renewed request will not be processed if the results of the previously acknowledged request are not available.

Note: All third-year modules of the programme as mentioned in the Programme examination regulations, are eligible and automatically approved for a personal minor. Approval is also automatically obtained for all interfaculty minors and faculty minors ("broadening" minors) of the University of Groningen. Examinees who select a personal minor packages that contain courses not provided by the BSc-psychology programme have to request approval. Courses or modules from Universities of Applied Sciences cannot be acknowledged for the minor part of the programme. A form and the procedure are published on the programme's Student Portal site.

Article 12 – Order during examinations

1. The Examinations Committee will ensure that invigilators are appointed to supervise written examinations; on behalf of the examiner, they will ensure that the examination proceeds in good order. The Examinations Committee will delegate this responsibility to the relevant examiner or his/her substitute.
2. Examinees must identify themselves by means of their student card at the request or behest of the Examinations Committee. Examinees may not participate in an examination if they are unable to identify themselves.

Note: in order to be able to control the registration of a examinee and his of her valid participation examinees have to legitimize by showing a valid student card. As an alternative an examiner may accept a valid identification document, such as a passport, driver's license or the like, which is mandatory for people of 14 years and older in The Netherlands. In that case the examinee has to show the student card afterwards to the examiner as soon as possible. If an examinee cannot identify him/herself this means that the examination will be declared invalid and the examinee will have to leave the room. In the case of examinations with many examinees it may be practically impossible to control each examinee present. However, participation does not imply validity of the examination. This means that afterwards, before the results become final, a result still may be declared invalid if it appears that it is based on an illegitimate participation, for instance due to non-registration as stipulated in Article 8 of these Rules and Regulations.

3. An examinee who arrives late for an examination may be banned from participation by the examiner.

Note: in practice a student will be granted access as long as no participating student did leave the room, with a maximum of half an hour for a 2-hour or longer exam, or proportionately shorter for shorter exams. This is not a right, and an examiner may decide otherwise.

4.
 - a. Examinees are obliged to follow all the directions published by the Examinations Committee or the examiner before the start of the final assessment or examination as well as those given by or on behalf of the examiner during the final assessment or examination or immediately afterwards.
 - b. During the exam no questions about the exam or the procedure are answered by or on behalf of the examiner, with the exception of issues not foreseen in these Rules & Regulations.
 - c. During an examination, only those documents provided or approved by or on behalf of the examiner are permitted.
5. Examinees may only leave the room where the examination is taking place with the permission of the examiner or invigilator. Leaving the room for a bathroom visit is not allowed; an exception may be made for students with a permit that was obtained from the committee before the exam. A reason for a permit may be that bathroom visits are medically necessary.
6. Examinees who have not registered for the examination or final assessment may not participate in the examination. The examiner, or his or her representative, may refuse that person to enter the examination location.

Note: see also the note added to subsection 2 of this article.

7. If an examinee ignores one or more of the directions referred to in subsection 4, or acts without permission as referred to in subsections 5 and 6, may be banned from further participation in the relevant examination by the Examinations Committee or the examiner.

8. The duration of an examination is such that the examinee may reasonably have enough time to answer the questions. All written examinations within the degree programme will last for two hours, unless otherwise indicated.
9. Practicals are a prerequisite for, or a part of an exam, as stipulated in the Programme examination regulations. The following rules of order are applicable:
 - a. Attending practicals is obligatory, as described in the Course Catalogue.
 - b. Student who do not attend or are too late, fail to meet this obligation.
 - c. Students may miss one session per block, provided they have announced this beforehand and there is a proven situation of Force Majeure.
Note: that means that "just being absent", or being absent due to a holiday, a celebration, a (VIP-) journey, or another situation without Force Majeure will not be accepted.
 - d. If a student misses a practical session for a legitimate reason, a make-up session or a replacing assignment will be provided that has minimally the duration and/or size of the missed session.
 - e. If a student missed the requirements of the practical then he/she (usually) will be excluded of (further) participation in the module.
10. Exclusion as referred to in subsection 2, 3, 7 or 8 means that no result will be provided for that examination.

Article 13 – Fraud

Note to article 9.16 of the Faculty examination regulations: examples of fraud consist of communicating during the exam in any means (chatting, non-verbal signalling, using electronic communication aids, etc.), copying or giving opportunity to copy and the like, whereby it makes it impossible to assess whether the work of a participating examinee was achieved by this examinee's own knowledge and effort.

Plagiarism in particular is a very serious type of fraud. Plagiarism is the adoption of the formulations of others without using quotation marks or stating the source, as well as the adoption of the ideas of others without stating the source.

Another example of fraud is providing a false statement to obtain an exemption or an alternative assignment for not attending an obligatory session, or obtaining a provision for a functional impairment, as described in article 9.8 of the Faculty examination regulation.

1. In the event of fraud during or in connection with an examination or final assessment, the Examinations Committee is authorised to exclude the examinee from further participation in the examination in question and/or from one or more exams or final assessments of the institution for a period of no more than one year after the discovery of the fraud, or impose another suitable measure.
In case of serious fraud the committee can propose the board of the university to permanently ban the examinee as a student of the programme.
2. A fraud investigation will be started as a result of a written report of an examiner concerning his or her detected or suspected case of fraud.
3. In cases requiring swift action, the examiner may decide to impose a provisional ban based on a verbal report by the invigilator or lecturer.
4. The Examinations Committee will inform the examinee in writing of the fact that a notification of fraud has been made that involves him or her.
5. The Examinations Committee shall give the examinee and the examiner the opportunity to put their cases.

6. The Examinations Committee will then decide whether or not to apply a measure within the meaning of subsection 2; the examinee and the examiner will be informed of the decision in writing.
7. A measure means that no result will be recorded for the examination or final assessment referred to in subsection 2.

Note: if the examinations committee detects that the result of an examination is based on fraud, the committee may annihilate the result, even when this result was declared definite. This is in accordance with judgements of the Board of Appeal for the Examinations, and the Judge in Administrative Law.

Article 14 – Scope of the examination

1. The scope of an examination shall not exceed the content of the sources upon which the examination is based. These sources will be made public in general terms before the start of the module that will prepare for the examination. The precise content of the examination subjects shall be published not later than six weeks before the examination.
2. The questions and assignments that comprise the examination will be divided as evenly as possible over the sources.
3. The examination will be representative of the learning objectives with regard to content and form.
4. The questions and assignments in the examination will be clear and contain sufficient indications of the detail required in the answers.
5. The form of examination listed in the course catalogue is the guiding principle. An examiner may only depart from this with the approval of the Examinations Committee, and must announce the change to a different type of examination at least six weeks in advance.

Article 15 – Assessment

1. The assessment of written examinations is conducted in line with assessment criteria set out in advance in writing.
2. The assessment of practicals can be conducted partly on the basis of a written progress test and a written final report.
3. The assessment of the 'Bachelor's thesis' is conducted in line with the agreements set out in the supervision contract between the examinee and the examiner.
4. The means of assessment is such that the examinee can check how the results of his or her examination have been arrived at.
5. A module within the degree programme is considered to have been passed if the final result is a 'Pass'. This is equivalent to a knowledge percentage of at least 56%.
6. In principle, the assessment will be expressed as a full number from the series 1 to 10. A 6 or above is considered to be a 'Pass', a 5 or lower as a 'Fail'. The committee can decide that the assessment is expressed differently, in which case the result always clearly expresses "Pass" or "Fail". Literature exams normally will be graded with a number, but may be graded with "Pass" or "Fail" if this can be motivated by the examiner.
7. A module which consists only of a practical, within the meaning of the description in the Examination Regulations, will be given either a 'Pass' or a 'Fail' grade. The modules 'Academic skills', 'Research practicum', 'Statistical solutions to research problems in psychology', and 'Bachelor's thesis' are exceptions – they will be assessed with a grade. The assessment of these four modules may also be expressed with a half (x.5) on condition that the assessment does not fall outside the series 1 to 10, and is not 5.5.

8. Examinees will be graded if during an examination the questions were handed to them, or they attended minimally one practical session. No grade will be given if the participation in the examination or practical was illegitimate, or a measure due to fraud is imposed.

Note: regulations in the Programme Examination Regulations about practicals that are passed in a previous year, remain valid, as is the case with exemptions.

9. Results from modules outside the programme will be handled as follows:
 - a. a module from the University of Groningen will be treated as a module of the programme and, if approved, the grade will be copied.
 - b. a module outside the University of Groningen, that was finished before the programme is commenced, will at approval result in exemption.
 - c. a module outside the University of Groningen that is started during the programme: modules from a Dutch university will at approval maintain the Dutch grade; modules from outside the Netherlands will at approval result in a "pass".

Note: Foreign modules will be acknowledged without copying any grades, due to the non-comparability of foreign grading systems. Note that this may possibly influence the award of the predicate "(summa) cum-laude". See article 7.12 from the Faculty Examination Regulations, and article 6 of these Rules & Regulations.

Article 16 – Quality Assurance for Examinations

1. To ensure quality assurance for examinations, the Examinations Committee will appoint an assessment committee.
2. The assessment committee will comprise at least two experts in the field of test construction and evaluation. They will be appointed by the Examinations Committee from the examiners for the degree programme. At least one member of the assessment committee will be a member of the Examinations Committee. The teaching quality officer of the Education Office of the degree programme will function as the official secretary of the assessment committee.
3. The assessment committee will meet at least once a semester and report on the quality of the examinations to the Examinations Committee and to the Degree Programme Advisory Committee.

Article 17 – Allocation of results and credits

1. No credits will be awarded for modules or module content for which credits already been awarded.
2. In contrast with the previous sentence: if from an examination for a module several valid results are registered or known, including exemptions, the most recent result will apply.
3. A result will be awarded as soon as an examinee could have seen the exam questions, or participated in at least one session of a practicum module, unless this is impossible due to rules in the programme examination regulations about a practicum as prerequisite for the exam result to become valid.

Article 18 – Announcement of the results

1. Once an examination or equivalent has been taken, the examiner will issue a statement to the Student Administration Office announcing the results. This statement will be signed by the examiner.
2. The statement referred to in subsection 1 may also contain a collective list of results, on condition that it is signed by the examiner and by a representative of the Student Administration Office for the degree programme.

3. At the end of oral examinations, the examiner will complete an exam slip and fill in the exam grade and his/her signature in the relevant places; duplicates will be immediately supplied to the examinee and to the Student Administration Office of the degree programme.

Article 19 – Right to inspection

1. As soon as possible after publication of the results of an oral examination, there will be a discussion of the results between the examiner and the examinee, either on request or at the initiative of the examiner. The results will then be explained.
2. The inspection as referred to in Article 9.14 of the Examination Regulations will take place at a time and place to be determined by the examiner, in any event before the potential resit.
3. If the Examinations Committee arranges a collective inspection for an examination, then an examinee may submit a request as defined in Article 9.14.1 of the Examination Regulations if he or she attended the collective inspection and motivates the request, or if he or she is unable to attend the collective inspection due to force majeure.
4. The provisions in subsection 3 also apply if the Examinations Committee or the examiner enable the examinee to compare his or her solutions with model answers.
5. The Examinations Committee or the examiner may permit exceptions to the provisions of subsections 2 and 3.

Article 20 – Standards

The examiners and the committee when making their decisions must adhere to the following standards:

1. The preservation of the quality and selection criteria of each examination
2. Effectiveness criteria, concentrating on:
 - a. reducing loss of time by examinees who are proceeding exceptionally well with their studies
 - b. timely termination of the degree programme by examinees who are unlikely to pass the exams
3. Protect examinees from themselves who want to do too much
4. Be understanding towards examinees who, through clear force majeure, have suffered study delay.

Article 21 – Amendments to the Rules and Regulations

No amendments shall be made that have an effect on the current academic year, unless the interests of examinees would otherwise be harmed.

Article 22 – Date of Commencement

These Rules and Regulations will take effect on 1 September 2016.

As decreed by the Examinations Committee of Psychology on 30 June 2016.

17. Code of Conduct

The guidelines below are intended to facilitate the smooth running of the teaching programme for both students and lecturers. Good communication is only possible if everyone obeys the rules, so everyone, both lecturers and students, is expected to comply with these guidelines.

1. Using the official e-mail address

All e-mail traffic will use the official University e-mail addresses. Please only use this e-mail address or link it to your personal e-mail address.

2. Be on time

Make sure that you are on time for lectures and all other teaching activities. Nothing is more annoying for students and lecturers than people who enter the lecture room after a lecture has begun. It's also very irritating if other people have to wait for you in group meetings.

3. Do not disturb

Do not disturb lectures and practicals by using your phone or talking to each other. Turn off your mobile or switch it to silent mode. Please do not make any noise in the library so that others can concentrate.

4. Communication etiquette

Please indicate clearly in letters or e-mails who the message is intended for, what it is about and who the sender is. Express yourself clearly and in good English. Address the other person properly, it's better to be too formal than too informal. The same applies to any reactions you may post on a Student Portal forum. Correct and suitable language use ensures that everyone can contribute to the discussions and questions on the forum in an enjoyable way.

5. Making recordings

Making audio and/or video recordings of educational activities such as lectures is only allowed with explicit permission of the lecturer. Recordings made under these conditions are only for personal use. Dissemination of these recordings is a violation of copy rights and may result in criminal prosecution.

6. Expectations

You may expect lecturers to indicate what medium they prefer for answering questions (orally during office hour or via the telephone, via e-mail or on Student Portal), and at what times they are available. You may expect lecturers to indicate during lectures and on Student Portal the term within which they will answer questions asked via e-mail or on Student Portal.

7. Questions

Please check whether the information you need can be found in the handbook or on Student Portal. Please also consider where or who you can best ask your question – on the Student Portal forum, the lecturer, the Education Desk, or maybe the porters, for example. Ask your questions in good time; don't wait until the day before the exam to ask questions about the material.

8. Cooperating in evaluations

Within the framework of quality assurance, all of our teaching is evaluated in various ways (written, oral). We expect you to cooperate with this. It is extremely important for the degree programme, and thus also for students, that we maintain the quality of teaching at a high level.

These guidelines are derived from the 'Golden Rules' of the Sociology degree programme.

18. Student charter

The Student Charter

The Student Charter provides an overview of the rights and obligations of both students and the University. It is based on national legislation, particularly the Higher Education and Research Act (WHW), supplemented by regulations that are specific to the University of Groningen. These latter regulations are set out in the appendices to the Student Charter.

The Act stipulates that the Student Charter comprises two sections: a university-wide section and a programme-specific section.

The **university-wide section** describes the rights and obligations that apply to the university as a whole, such as registration and protection of rights. You can find this section on the internet (www.rug.nl/studenten/ > Legal position > Students' Charter).

The university-wide section of the Student Charter does not literally quote the articles from acts and regulations but describes them as clearly as possible. The various topics are accompanied by links to the relevant articles of the act or regulation in question.

The **programme-specific sections** describe the rights and obligations that apply to specific degree programmes. These sections include the Teaching and Examination Regulations (OER), Rules and Regulations for examinations and final assessment and other regulations and provisions set by the various degree programmes and faculties. You can consult your programme-specific section at the faculty Education Offices and in the Study Guides.

Applicability

The Student Charter applies to academic year 2010-2011. The university-wide section of the Student Charter is approved annually by the Board of the University and endorsed by the University Council. In the event that the Charter challenges or contradicts any legal regulations, these legal regulations will take priority.

Publication

At the start of the academic year all students will be sent an e-mail by the Board of the University informing them where they can find the Student Charter on the internet and where they can consult a hardcopy of the Student Charter.

Using the Student Charter

All students are expected to be familiar with the contents of the Student Charter. Not complying with the rules in the Charter may affect your rights, for example the right to financial support from the Graduation Fund.

Some of these regulations may not be as hard and fast as they sound. Rules and regulations are by definition general in character, and this Student Charter is no exception. This means that the applicability of these regulations in concrete situations and individual instances is not always a predictable and straightforward matter. Students who have registered for the first time this year may find that the regulations that apply to them are different to those for students who have reregistered. Make sure you are provided with the right information by your faculty and/or the Student Service Centre (SSC) and read the Student Charter and the associated regulations carefully!

Items in the Student Charter

The university-wide section of the Student Charter contains information on the rights and obligations of students regarding the following items:

- admission,
- registration and deregistration,
- teaching, including the binding study advice,
- examinations and final assessments,
- financial assistance,
- consultative participation,
- rules of behaviour,
- legal rights.

19. Addresses Central bodies University of Groningen

GENERAL ADDRESSES

Board of the University (CvB)

Postal address: P.O. Box 72, 9700 AB Groningen, the Netherlands

Telephone: (050) 363 5285

University Council (U-raad)

Postal address: P.O. Box 72, 9700 AB Groningen, the Netherlands

Telephone: (050) 363 8535

E-mail: uraad@rug.nl

Internet: www.rug.nl/uraad

Legal Affairs Office (ABJZ)

Postal address: P.O. Box 72, 9700 AB Groningen, the Netherlands

Telephone: (050) 363 5440

E-mail: abjz@rug.nl

Internet: myuniversity.rug.nl/infonet/medewerkers/organisatie/bvdu/abjz

Donald Smits Center for Information Technology (CIT)

Visiting address: Zernikeborg, Nettelbosje 1

Postal address: P.O. Box 11044, 9700 CA Groningen, the Netherlands

Telephone: (050) 363 9200

E-mail: secretariaat-cit@rug.nl

Internet: www.rug.nl/cit

CIT Helpdesk

Telephone: (050) 363 3232

E-mail: servicedesk.cit@rug.nl

Health, Safety and Environment Service (AMD)

Visiting and postal address: Visserstraat 49, 9712 CT Groningen, the Netherlands

Telephone: (050) 363 5551

E-mail: amd@rug.nl

Internet: www.rug.nl/amd

Office of the Confidential Advisor

Marijke Dam, Confidential Advisor

Visiting and postal address: Visserstraat 47, 9712 CT Groningen, the Netherlands

Telephone: (050) 363 5435

E-mail: j.m.dam@rug.nl

Internet: www.rug.nl/vertrouwenspersoon

Complaints Committee for harassment, sexual harassment and aggressive, violent or discriminatory behaviour

Postal address: Antwoordnummer 172, 9700 AB Groningen

ADDRESSES FOR STUDENTS

University Student Desk (USD)

Visiting address: Broerstraat 5

Postal address: P.O. Box 72, 9700 AB Groningen, the Netherlands

Telephone: (050) 363 8004

Internet/e-mail: www.rug.nl/insandouts or www.rug.nl/usd or myuniversity > frequently asked questions

International Service Desk (ISD)

Visiting address: Broerstraat 5

Postal address: P.O. Box 72, 9700 AB Groningen, the Netherlands

Telephone: (050) 363 8181

E-mail: isd@rug.nl

Internet: www.rug.nl/isd

Student Service Centre

Visiting address: Uurwerkersgang 10

Postal address: P.O. Box 72, 9700 AB Groningen, the Netherlands

Telephone: (050) 363 8066

E-mail: ssc-secretariaat@rug.nl

Internet: www.rug.nl/ssc

NEXT Careers Advice

Visiting address: Uurwerkersgang 10

Postal address: P.O. Box 72, 9700 AB Groningen, the Netherlands

Email: next@rug.nl

Internet: www.rug.nl/next

Central Portal for the Legal Protection of Student Rights (CLRS).

Internet/e-mail: www.rug.nl/clrs or myuniversity > frequently asked questions

Postal address: P.O. Box 72, 9700 AB Groningen, the Netherlands

University Funds Committee (UFC)

Postal address: P.O. Box 72, 9700 AB Groningen, the Netherlands

E-mail: ufc@rug.nl

Appendix: adaptations Study Guide as from August 2016

Per 26-08-2016 SH

Changed 'nestor' into 'Student Portal'

P.25: added: * For your second year you must choose BE2-23 or/and BE2-24. During your third year you can follow the other course.

p.27, 29, 60: removed PSB3E-IO05

p.25 2nd Year Overview: added PSBE2-14 Academic Fields

Per 07-09-2016 JR

P.10: addition to rule for Binding Study Advice

Per 10-10-2016 SH

P. 19: changed office hours J.A.M. Heesink

P. 27, 29, 62: removed PSB3E-SP08 Mass psychology

Per 24-10-2016 SH

P. 27, 29, 62: added PSB3E-SP08 Mass psychology

Per 21-12-2016 SH

P. 64; article 3.6 Equivalences: added information